



— 2018 —
PRODUCT CATALOGUE



Pınar Döküm started toll manufacturing in 1984 in industrial sector and in 1994 it created Nesil brand within framework of customer oriented understanding together with growing goal. Pınar Döküm performed manufacturing in 20.000 square meter area in Konya. It provides many products such as sliding valve, fire hydrants, checkvalves, agricultural irrigation hydrants, butterfly valves, dismantling parts, cast joints and many products with its customers under Nesil brand.

It has Brand registration, TSE, TSEK, TS EN ISO 9001-2015 and CE certificates within framework of quality understanding.

Prior objective of our company is continuously improving product quality, to increase sales volume and production capacity properly and to present best quality with most suitable price by standard and mass production.



Pinar Döküm which continues to grow in sector is rightfully proud of using power and energy which are received for you for using again in service for you.



WE PRODUCE TECHNOLOGY
**WHICH DIRECTS
WATER**



www.nesilvana.com



F5 METAL BED SLIDING VALVE

TSEN 1171

It is connected to pipe which has closure system in curtain form by slide and used for stopping flow of fluid inside pipe. Slide moves up and down by screwed shaft which is mounted inside housing and open and close operations for valve is implemented. Sealing is maintained by bushings which are installed over housing and slide. It is used for non abrasive liquids and liquid fuel installations. It is not used with control purposes and flow adjustments.

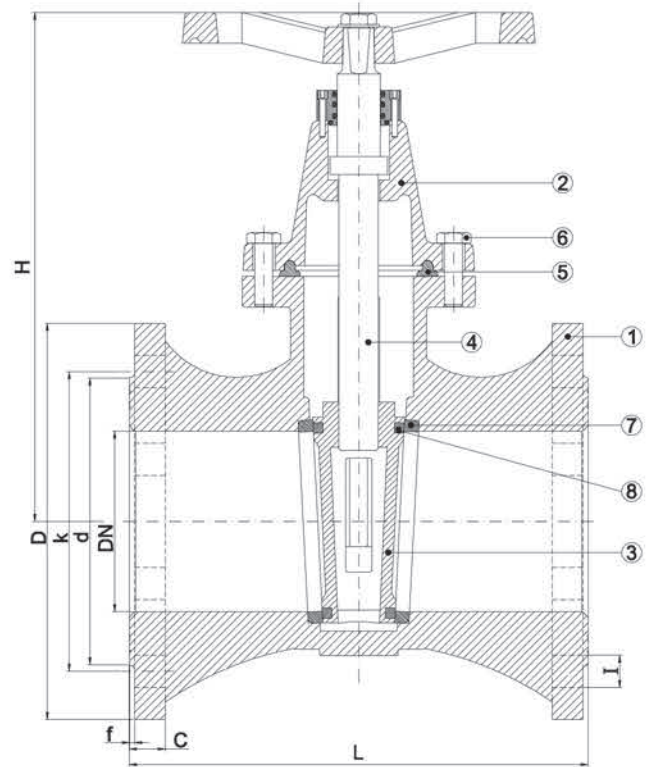

DN (RATED DIAMETER) (mm)	D (mm)	k (mm)	d (mm)	f (mm)	C (mm)	I Hole diameter and quantity	L (mm)	H (mm)	Weight (Kg)
Ø50 (PN10-16-25)	165	125	99	3	20	Ø19x4 adet	250	210	14.5
Ø65 (PN10-16-25)	185	145	118	3	20	Ø19x4 adet	270	230	18
Ø80 (PN10-16-25)	200	160	132	3	22	Ø19x8 adet	280	255	21
Ø100 (PN10-16)	220	180	156	3	24	Ø19x8 adet	300	300	27
Ø100 (PN25)	235	190	156	3	28	Ø23x8 adet	300	300	30
Ø125 (PN10-16)	250	210	184	3	26	Ø19x8 adet	325	350	44
Ø125 (PN25)	270	220	184	3	30	Ø28x8 adet	325	350	48
Ø150 (PN10-16)	285	240	211	3	26	Ø23x8 adet	350	410	59
Ø150 (PN25)	300	250	211	3	34	Ø28x8 adet	350	410	66
Ø200 (PN10)	340	295	266	4	26	Ø23x8 adet	400	480	90
Ø200 (PN16)	340	295	266	4	30	Ø23x12 adet	400	480	90
Ø200 (PN25)	360	310	274	4	34	Ø28x12 adet	400	480	98
Ø250 (PN10)	395	350	319	4	28	Ø23x12 adet	450	600	140
Ø250 (PN16)	405	355	319	4	32	Ø28x12 adet	450	600	140
Ø250 (PN25)	425	370	330	4	36	Ø31x12 adet	450	600	154
Ø300 (PN10)	445	400	370	4	28	Ø23x12 adet	500	690	206
Ø300 (PN16)	460	410	370	4	32	Ø28x12 adet	500	690	206
Ø300 (PN25)	485	430	389	4	40	Ø31x16 adet	500	690	226
Ø350 (PN10)	505	460	429	4	30	Ø23x16 adet	550	900	249
Ø350 (PN16)	520	470	429	4	36	Ø28x16 adet	550	900	249
Ø350 (PN25)	555	490	448	4	44	Ø34x16 adet	550	900	273
Ø400 (PN10)	565	515	480	4	32	Ø28x16 adet	600	960	418
Ø400 (PN16)	580	525	480	4	38	Ø31x16 adet	600	960	418
Ø400 (PN25)	620	550	503	4	48	Ø37x16 adet	600	960	460

NO	NAME OF PART	MATERIAL
1	HOUSING	EN-GJS-400 (GGG40) EN-GJS-500 (GGG50)
2	COVER	EN-GJS-400 (GGG40) EN-GJS-500 (GGG50)
3	SLIDE	EN-GJS-400-500 (GGG40-50) + EPDM COATED
4	SHAFT	X20Cr13
5	COVER GASKET	EPDM
6	COVER BOLTS	8.8 İMBUS
7	ACTUATOR LOAF	MS58
8	BOLT LOAF (125-400)	MS58

TSEN 1171

F4 METAL BED SLIDING VALVE

It is connected to pipe which has closure system in curtain form by slide and used for stopping flow of fluid inside pipe. Slide moves up and down by screwed shaft which is mounted inside housing and open and close operations for valve is implemented. Sealing is maintained by bushings which are installed over housing and slide. It is used for non abrasive liquids and liquid fuel installations. It is not used with control purposes and flow adjustments.

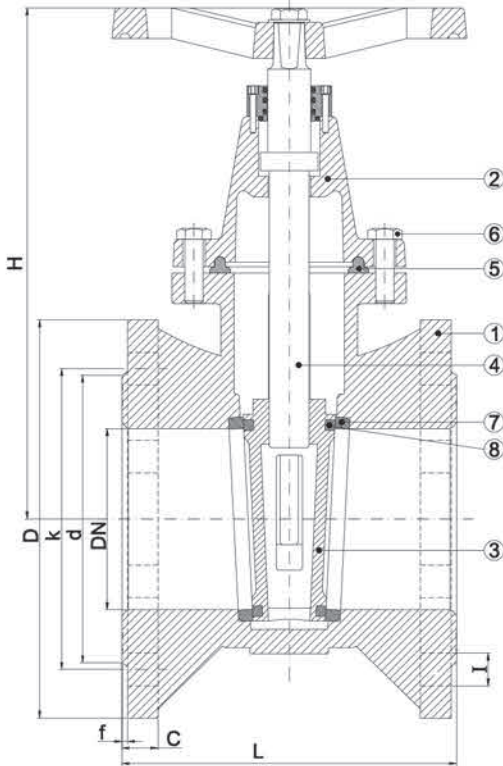

F4 METAL BED VALVE DIMENSION TABLE									
DN (RATED DIAMETER) (mm)	D (mm)	k (mm)	d (mm)	f (mm)	C (mm)	I Hole diameter and quantity	L (mm)	H (mm)	Weight (Kg)
Ø50 (PN10-16-25)	165	125	99	3	20	Ø19x4 adet	150	210	12
Ø65 (PN10-16-25)	185	145	118	3	20	Ø19x4 adet	170	230	16
Ø80 (PN10-16-25)	200	160	132	3	22	Ø19x8 adet	180	255	19
Ø100 (PN10-16)	220	180	156	3	24	Ø19x8 adet	190	300	24
Ø100 (PN25)	235	190	156	3	28	Ø23x8 adet	190	300	27
Ø125 (PN10-16)	250	210	184	3	26	Ø19x8 adet	200	350	38
Ø125 (PN25)	270	220	184	3	30	Ø28x8 adet	200	350	42
Ø150 (PN10-16)	285	240	211	3	26	Ø23x8 adet	210	410	50,5
Ø150 (PN25)	300	250	211	3	34	Ø28x8 adet	210	410	57,5
Ø200 (PN10)	340	295	266	4	26	Ø23x8 adet	230	480	79,5
Ø200 (PN16)	340	295	266	4	30	Ø23x12 adet	230	480	79,5
Ø200 (PN25)	360	310	274	4	34	Ø28x12 adet	230	480	88
Ø250 (PN10)	395	350	319	4	28	Ø23x12 adet	250	600	118
Ø250 (PN16)	405	355	319	4	32	Ø28x12 adet	250	600	118
Ø250 (PN25)	425	370	330	4	36	Ø31x12 adet	250	600	130
Ø300 (PN10)	445	400	370	4	28	Ø23x12 adet	270	690	165
Ø300 (PN16)	460	410	370	4	32	Ø28x12 adet	270	690	165
Ø300 (PN25)	485	430	389	4	40	Ø31x16 adet	270	690	181
Ø350 (PN10)	505	460	429	4	30	Ø23x16 adet	290	900	217
Ø350 (PN16)	520	470	429	4	36	Ø28x16 adet	290	900	217
Ø350 (PN25)	555	490	448	4	44	Ø34x16 adet	290	900	238

F4 METAL BED VALVE PARTS		
NO	NAME OF PART	MATERIAL
1	HOUSING	EN-GJS-400 (GGG40) EN-GJS-500 (GGG50)
2	COVER	EN-GJS-400 (GGG40) EN-GJS-500 (GGG50)
3	SLIDE	EN-GJS-400-500 (GGG40-50) + EPDM COATED
4	SHAFT	X20Cr13
5	COVER GASKET	EPDM
6	COVER BOLTS	8.8 İMBUS
7	ACTUATOR LOAF	MS58
8	BOLT LOAF (125-350)	MS58

F5 ELASTOMER SLIDING VALVE

TSEN 1171

These valves have closure system in screen form by means of slide and connected to pipe lines and used for stopping fluid inside pipe. Screwed shaft which is mounted inside housing moves slide up and down and performs open and close operation for valve. Sealing is maintained by gasket which is coated over slide. They are used liquids which do not have abrasive property and in liquid fuel installations. They are not used for controlling and flow adjustment.

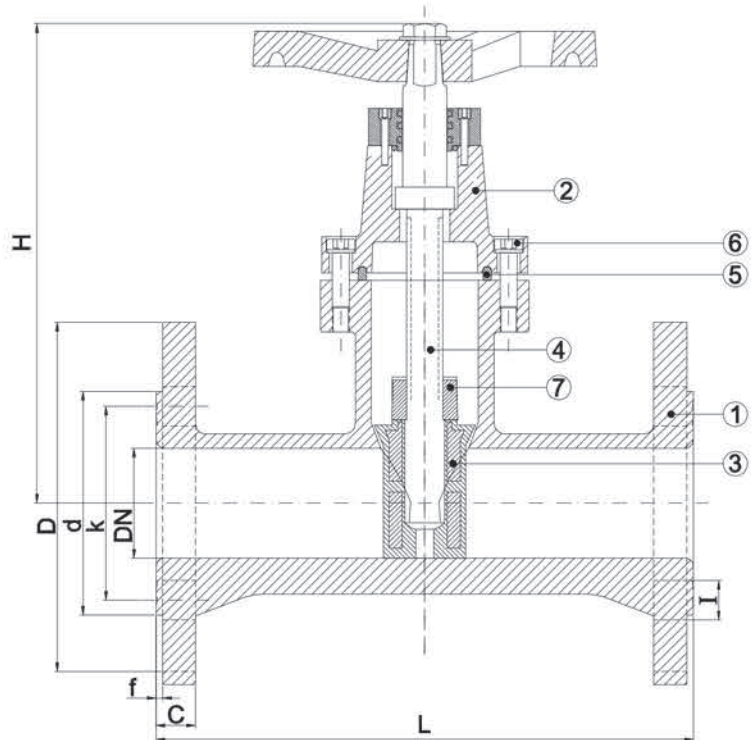

F5 ELASTOMER VALVE DIMENSION TABLE									
DN (RATED DIAMETER) (mm)	D (mm)	k (mm)	d (mm)	f (mm)	C (mm)	I Hole Diameter and quantity	L (mm)	H (mm)	Weight (Kg)
Ø50 (PN10-16-25)	165	125	99	3	20	Ø19x4 adet	250	210	12
Ø65 (PN10-16-25)	185	145	118	3	20	Ø19x4 adet	270	240	16,5
Ø80 (PN10-16-25)	200	160	132	3	22	Ø19x8 adet	280	280	21
Ø100 (PN10-16)	220	180	156	3	24	Ø19x8 adet	300	310	26
Ø100 (PN25)	235	190	156	3	28	Ø23x8 adet	300	310	29
Ø125 (PN10-16)	250	210	184	3	26	Ø19x8 adet	325	350	45
Ø125 (PN25)	270	220	184	3	30	Ø28x8 adet	325	350	49
Ø150 (PN10-16)	285	240	211	3	26	Ø23x8 adet	350	400	51
Ø150 (PN25)	300	250	211	3	34	Ø28x8 adet	350	400	58
Ø200 (PN10)	340	295	266	4	26	Ø23x8 adet	400	520	93
Ø200 (PN16)	340	295	266	4	30	Ø23x12 adet	400	520	93
Ø200 (PN25)	360	310	274	4	34	Ø28x12 adet	400	520	101
Ø250 (PN10)	395	350	319	4	28	Ø23x12 adet	450	610	150
Ø250 (PN16)	405	355	319	4	32	Ø28x12 adet	450	610	150
Ø250 (PN25)	425	370	330	4	36	Ø31x12 adet	450	610	163
Ø300 (PN10)	445	400	370	4	28	Ø23x12 adet	500	695	180
Ø300 (PN16)	460	410	370	4	32	Ø28x12 adet	500	695	180
Ø300 (PN25)	485	430	389	4	40	Ø31x16 adet	500	695	196
Ø350 (PN10)	505	460	429	4	30	Ø23x16 adet	550	850	290
Ø350 (PN16)	520	470	429	4	36	Ø28x16 adet	550	850	290
Ø350 (PN25)	555	490	448	4	44	Ø34x16 adet	550	850	310
Ø400 (PN10)	565	515	480	4	32	Ø28x16 adet	600	950	370
Ø400 (PN16)	580	525	480	4	38	Ø31x16 adet	600	950	380
Ø400 (PN25)	620	550	503	4	48	Ø37x16 adet	600	950	405
Ø500 (PN10)	670	620	582	4	34	Ø28x20 adet	700	1040	630
Ø500 (PN16)	715	650	609	4	42	Ø34x20 adet	700	1040	650
Ø500 (PN25)	730	660	609	4	52	Ø37x20 adet	700	1040	690

F5 ELAST. SLIDED VALVE PARTS		
NO	NAME OF PART	MATERIAL
1	HOUSING	EN-GJS-400 (GGG40) EN-GJS-500 (GGG50)
2	COVER	EN-GJS-400 (GGG40) EN-GJS-500 (GGG50)
3	SLIDE	EN-GJS-400-500 (GGG40-50) + EPDM COATED
4	SHAFT	X20Cr13
5	COVER GASKET	EPDM
6	COVER BOLTS	8.8 İMBUS
7	ACTUATOR LOAF	M558

TSEN 1171

F4 ELASTOMER SLIDING VALVE

These valves have closure system in screen form by means of slide and connected to pipe lines and used for stopping fluid inside pipe. Screwed shaft which is mounted inside housing moves slide up and down and performs open and close operation for valve. Sealing is maintained by gasket which is coated over slide. They are used liquids which do not have abrasive property and in liquid fuel installations. They are not used for controlling and flow adjustment.

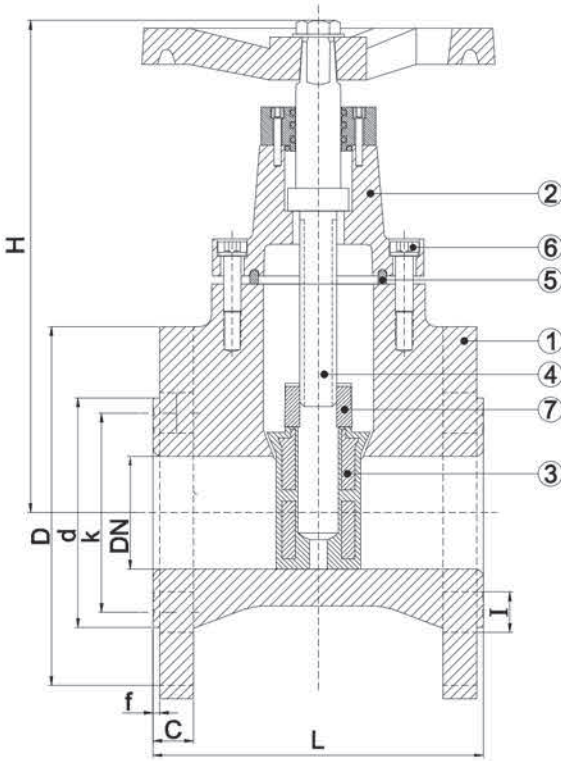

F4 ELASTOMER VALVE DIMENSION TABLE									
DN (RATED DIAMETER) (mm)	D (mm)	k (mm)	d (mm)	f (mm)	C (mm)	I Hole Diameter and quantity	L (mm)	H (mm)	Weight (Kg)
Ø50 (PN10-16-25)	165	125	99	3	20	Ø19x4 adet	150	210	11
Ø65 (PN10-16-25)	185	145	118	3	20	Ø19x4 adet	170	240	15
Ø80 (PN10-16-25)	200	160	132	3	22	Ø19x8 adet	180	280	20
Ø100 (PN10-16)	220	180	156	3	24	Ø19x8 adet	190	310	24
Ø100 (PN25)	235	190	156	3	28	Ø23x8 adet	190	310	27
Ø125 (PN10-16)	250	210	184	3	26	Ø19x8 adet	200	350	36
Ø125 (PN25)	270	220	184	3	30	Ø28x8 adet	200	350	40
Ø150 (PN10-16)	285	240	211	3	26	Ø23x8 adet	210	400	47
Ø150 (PN25)	300	250	211	3	34	Ø28x8 adet	210	400	54
Ø200 (PN10)	340	295	266	4	26	Ø23x8 adet	230	520	79,5
Ø200 (PN16)	340	295	266	4	30	Ø23x12 adet	230	520	79,5
Ø200 (PN25)	360	310	274	4	34	Ø28x12 adet	230	520	88
Ø250 (PN10)	395	350	319	4	28	Ø23x12 adet	250	610	122
Ø250 (PN16)	405	355	319	4	32	Ø28x12 adet	250	610	122
Ø250 (PN25)	425	370	330	4	36	Ø31x12 adet	250	610	134
Ø300 (PN10)	445	400	370	4	28	Ø23x12 adet	270	695	164
Ø300 (PN16)	460	410	370	4	32	Ø28x12 adet	270	695	164
Ø300 (PN25)	485	430	389	4	40	Ø31x16 adet	270	695	176
Ø350 (PN10)	505	460	429	4	30	Ø23x16 adet	290	850	200
Ø350 (PN16)	520	470	429	4	36	Ø28x16 adet	290	850	200
Ø350 (PN25)	555	490	448	4	44	Ø34x16 adet	290	850	220
Ø400 (PN10)	565	515	480	4	32	Ø28x16 adet	310	950	300
Ø400 (PN16)	580	525	480	4	38	Ø31x16 adet	310	950	310
Ø400 (PN25)	620	550	503	4	48	Ø37x16 adet	310	950	330
Ø450 (PN10)	615	565	530	4	32	Ø28x20 adet	330	1040	350
Ø450 (PN16)	640	585	548	4	40	Ø31x20 adet	330	1040	370
Ø450 (PN25)	670	600	548	4	50	Ø37x20 adet	330	1040	385
Ø500 (PN10)	670	620	582	4	34	Ø28x20 adet	350	1040	350
Ø500 (PN16)	715	650	609	4	42	Ø34x20 adet	350	1040	370
Ø500 (PN25)	730	660	609	4	52	Ø37x20 adet	350	1040	385
Ø600 (PN10)	780	725	682	5	36	Ø31x20 adet	390	1250	630
Ø600 (PN16)	840	770	720	5	48	Ø37x20 adet	390	1250	650
Ø600 (PN25)	845	770	720	5	56	Ø41x20 adet	390	1250	693

F4 ELAST. SLIDED VALVE PARTS		
NO	NAME OF PART	MATERIAL
1	HOUSING	EN-GJS-400 (GGG40) EN-GJS-500 (GGG50)
2	COVER	EN-GJS-400 (GGG40) EN-GJS-500 (GGG50)
3	SLIDE	EN-GJS-400-500 (GGG40-50) + EPDM COATED
4	SHAFT	X20Cr13
5	COVER GASKET	EPDM
6	COVER BOLTS	8.8 İMBUS
7	ACTUATOR LOAF	MS58

CENTRAL HEATER VALVE

TSEN 1171

It is connected to pipe which has closure system in curtain form by slide and used for stopping flow of fluid inside pipe. Slide moves up and down by screwed shaft which is mounted inside housing and open and close operations for valve is implemented. Sealing is maintained by bushings which are installed over housing and slide. It is used for non abrasive liquids and liquid fuel installations. It is not used with control purposes and flow adjustments.

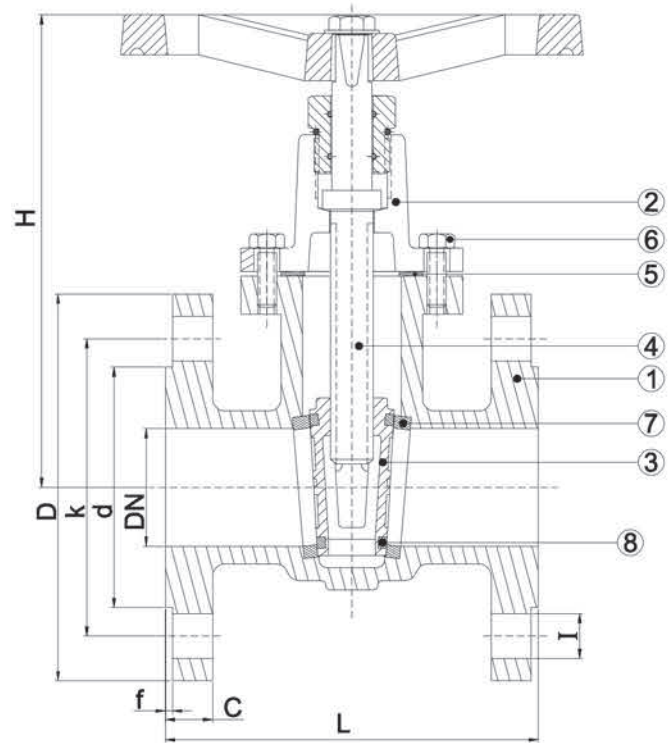

CENTRAL HEATER VALVE PARTS		
NO	NAME OF PART	MATERIAL
1	HOUSING	EN-GJS-400 (GGG40) EN-GJS-500 (GGG50)
2	COVER	EN-GJS-400 (GGG40) EN-GJS-500 (GGG50)
3	SLIDE	50-100 = MS58
		125-150 = EN-GJS-400-500 (GGG40-50)
4	SHAFT	X20Cr13
5	COVER GASKET	EPDM
6	COPPER BOLT	8.8 GALVANIZED
7	HOUSING BUSHING	MS58
8	SLIDING BUSHING (125 -150 arasi)	MS58

CENTRAL HEATER VALVE DIMENSION TABLE									
DN (RATED DIAMETER) (mm)	D	k	d	f	c	I diameter and quantity	L	H	WIGHT T
	(mm)	(mm)	(mm)	(mm)	(mm)		(mm)	(mm)	(Kg)
050 (PN6)	140	110	88	3	16	014x4 pieces	150	210	11
065 (PN6)	160	130	108	3	16	014x4 pieces	170	230	15
080 (PN6)	190	150	124	3	18	019x4 pieces	180	255	20
0100 (PN6)	210	170	144	3	18	019x4 pieces	190	300	25
0125 (PN6)	240	200	174	3	20	019x8 pieces	200	350	40
0150 (PN6)	265	225	199	3	20	019x8 pieces	210	410	50

AGRICULTURAL IRRIGATION VALVE (RECEIVER)

TSEK ÜBM-00-BK-000

These are simple structured water intake valves which delivers water to land in agricultural pressurized irrigation systems. User directly connect irrigation pipes o outlet of receiver valve and perform irrigation. Outlets of valves are designed such that they can be installed over standard sprinkler irrigation pipes. Optionally they can be produced with flanged outlet type.

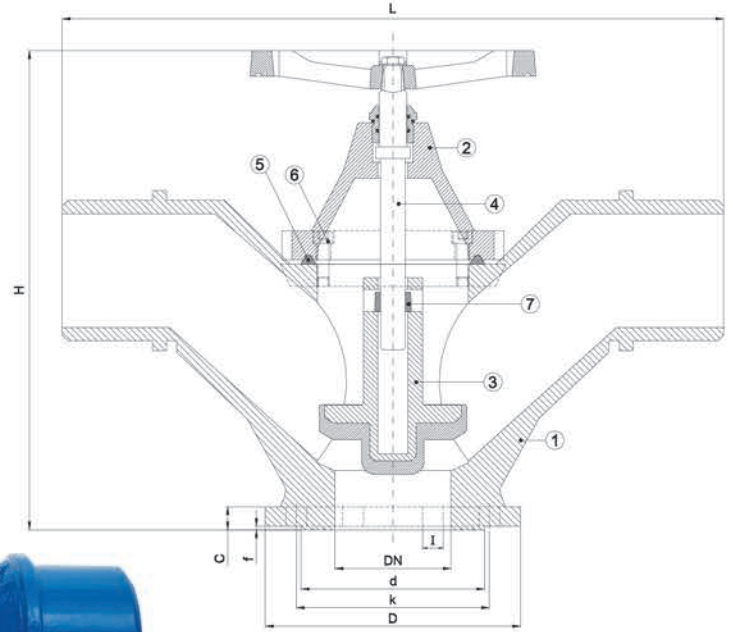

PARTS OF RECEIVER VALVE		
NO	PART'S NAME	MATERIAL
1	HOUSING	EN-GJL-250 (GG25) EN-GJS-400 (GGG40) EN-GJS-500 (GGG50)
2	COVER	EN-GJL-250 (GG25) EN-GJS-400 (GGG40) EN-GJS-500 (GGG50)
3	SLIDE	EN-GJL-250 (GG25)
		EN-GJS-400-500 (GGG40-50) + EPDM KAPLI
4	SHAFT	X20Cr13
5	COVER SEALING	EPDM
6	COVER BOLTS	8.8 İMBUS
7	ACTUATING LOAF	MS58

RECEIVER VALVE DIMENSION TABLE									
DN (RATED DIAMETER) (mm)	D	k	d	f	C	I Hole diameter and quantity	L	H	WEIGHT (Kg)
	(mm)	(mm)	(mm)	(mm)	(mm)		(mm)	(mm)	
0100 (PN10-16)	220	180	156	3	24	019x8 pieces	300	300	27
0125 (PN10-16)	250	210	184	3	26	019x8 pieces	325	350	44
0150 (PN10-16)	285	240	211	3	26	023x8 pieces	350	410	59

GROUND HYDRANT

TSEN 14384

These are hydrants which is used for water intake in compressed water network, of which two outlet water intake structure is located above ground (optionally 3 outlet). Hydrant consists of shaft which controls valve, spring valve(checkvalve) which serves for automatic discharge, hose connection glands, casting parts which form main housing.

Open close operations are made by controlling shaft by hydrant switch. When shaft is rotated counterclockwise, movement pipe will move downwards. Thereby valve parts which are present inside housing move downwards and hydrant is opened. Valve is closed at water flow direction. Thereby sealing of valve which is under pressure is improved. This system forms a turbulence free and linear flow as well they reduce pressure loss, prevent vibrations and extends service lifetime of valves. Thereby spraying water at long distances is maintained. Hydrants should be closed in cold weather for discharging water inside hydrant by valve. Spring valve will open since there is not pressure and discharges water over ground through valve.

FLANGE DIMENSION TABLE							
DN (RATED DIAMETER) (mm)	D (mm)	k (mm)	d (mm)	f (mm)	C (mm)	Hole diameter and quantity	
80	200	160	132	3	22	019x8 pieces	
100	220	180	156	3	24	019x8 pieces	

UNDERGROUND FIRE HYDRANT DIMENSION TABLE								
DN Rated diameter mm	Size	H1 mm	H2mm	H3mm	H4mm	H5mm	H mm	Weight kg
80	Short size 1	226	501			522	1250	64
80	Short size 2	226	702			522	1450	67
80	Medium Size	226	501	501		522	1750	79
80	Long Size	226	501	501	500	522	2150	92
100	Short size 1	226	501			522	1250	68
100	Short size 2	226	702			522	1450	72
100	Medium Size	226	501	501		522	1750	85
100	Long Size	226	501	501	400	522	2150	99

GROUND FIRE HYDRANT PARTS		
NO	NAME OF PART	MATERIAL
	LOWER HOUSING	EN-GJL-250 (GG25)
2	LOWER PIPE	EN-GJL-250 (GG25)
3	UPPER PIPE	EN-GJL-250 (GG25)
4	UPPER COVER	EN-GJL-250 (GG25)
5	SLIDE FOOT	EN-GJL-250 (GG25)
6	SLIDE HOUSING	EN-GJS-400 (GGG40) EN-GJS-500 (GGG50)
7	SEALING BEARING	MS58
8	ACTUATION PIPE	GALVANIZED PIPE
9	SHAFT	X20Cr13
10	ACTUATION LOAF	MS5B
11	UPPER PRESS	EN-GJL-250 (GG25)
12	FLYWHEEL	EN-GJL-250 (GG25)
13	OUTLET OPENING	ALUMINUM
14	RELEASE VALVE	MS58
15	GASKETS	EPDM
16	LOAF AND BOLTS	8.8 GALVANIZED
17	EXTENSION PIPE	EN-GJL-250 (GG25)

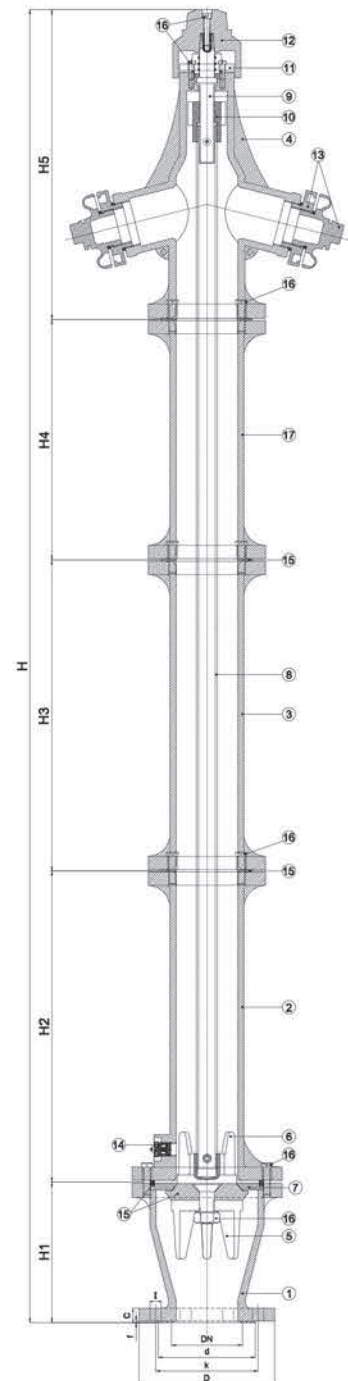

SPRING TYPE GROUND FIRE HYDRANT

TSEN 14384

These are hydrants which is used for water intake in compressed water network, of which two outlet water intake structure is located above ground (optionally 3 outlet). Hydrant consists of shaft which controls valve, spring valve(checkvalve) which serves for automatic discharge, hose connection glands, casting parts which form main housing. Open close operations are made by controlling shaft by hydrant switch. When shaft is rotated counterclockwise, movement pipe will move downwards. Thereby valve parts which are present inside housing move downwards and hydrant is opened. Valve is closed at water flow direction. Thereby sealing of valve which is under pressure is improved. This system forms a turbulence free and linear flow as well they reduce pressure loss, prevent vibrations and extends service lifetime of valves. Thereby spraying water at long distances is maintained. Hydrants should be closed in cold weather for discharging water inside hydrant by valve. Spring valve will open since there is not pressure and discharges water over ground through valve.

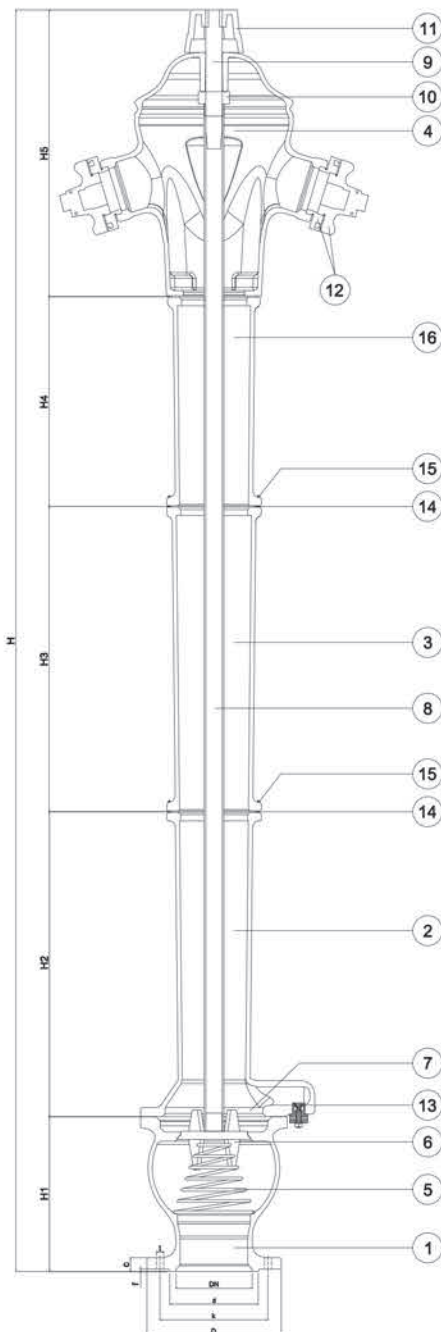

DN (RATED DIAMETER) (mm)	D (mm)	k (mm)	d (mm)	f (mm)	C (mm)	Hole diameter and quantity
80	200	160	132	3	22	019x8 pieces
100	220	180	156	3	24	019x8 pieces

NO	NAME OF PART	MATERIAL
1	LOWER BODY	EN-GJS-400 (GGG40) EN-GJS-500 (GGG50)
2	LOWER PIPE	EN-GJS-400 (GGG40) EN-GJS-500 (GGG50)
3	UPPER PIPE	EN-GJS-400 (GGG40) EN-GJS-500 (GGG50)
4	UPPER BODY	EN-GJS-400 (GGG40) EN-GJS-500 (GGG50)
5	SPRING	STANDARD
6	SLIDE	EN-GJS-400-500 (GGG40-50) +EPDM COATED
7	SEALING BED	MSS8
8	ACTUATOR PIPE	GALVANIZED PIPE
9	ACTUATOR SHAFT	X20CM3
10	ACTUATOR LOAF	MSS8
11	FLYWHEEL	EN-GJS-400 (GGG40) EN-GJS-500 (GGG50)
12	OUTLET OPENING	ALUMINUM
13	RELIEF VALVE	MSS8
14	GASKET	EPDM
15	BOLT AND LOAFS	8.8 GALVANIZED
16	EXTENSION PIPE	EN-GJS-400 (GGG40) EN-GJS-500 (GGG50)

DN Rated diameter mm	Size	H1 mm	H2mm	H3mm	H4mm	H5mm	H mm	Weight kg
80	Short size 1	250	501			498	1250	48
80	Short size 2	250	702			498	1450	52
80	Medium Size	250	501	501		498	1750	64
80	Long Size	250	501	501	400	498	2150	74
100	Short size 1	250	501			498	1250	52
100	Short size 2	250	702			498	1450	57
100	Medium Size	250	501	501		498	1750	70
100	Long Size	250	501	501	400	498	2150	84

UNDERGROUND FIRE HYDRANT (NEW MODEL)

TSEN 14339

These are hydrants of which water intake structure is below ground in compressed water network and cover is located above ground. Hydrant consists of Shaft which controls hydrant valve, cast parts which form housing and hose connections. Open and close operations for hydrant are made by controlling shaft by key. Underground fire hydrants are used for providing water for fire brigade in factories, warehouses, industrial plants, around of building, forest area which are sensitive against fire and residence areas.

FLANGE DIMENSION TABLE						
DN (RATED DIAMTER) (mm)	D (mm)	k (mm)	d (mm)	f (mm)	C (mm)	Hole dieamter and quantity
80	200	160	132	3	22	019x8 pieces
100	220	180	156	3	24	019x8 pieces

UNDERGROUND FIRE HYDRANT DIMENSION TABLE					
DN (mm) (RATED DIAMETER)	H1 (mm)	H2 (mm)	H3 (mm)	H (mm)	WEIGHT (Kg)
80	267	396	315	978	52
100	277	396	315	988	56

UNDERGROUND FIRE HYDRANT PARTS		
NO	NAME OF PART	MATERIAL
1	NPART (HEEL)	EN-GJL-250 (GG25) EN-GJS-400 (GGG40) EN-GJS-500 (GG50)
2	PIPE	EN-GJL-250 (GG25) EN-GJS-400 (GGG40) EN-GJS-500 (GG50)
3	UPPER BODY	EN-GJL-250 (GG25) EN-GJS-400 (GGG40) EN-GJS-500 (GG50)
4	COVER	EN-GJL-250 (GG25) EN-GJS-400 (GGG40) EN-GJS-500 (GG50)
5	SLIDE	EN-GJL-250 (GG25) EN-GJS-400 (GGG40) EN-GJS-500 (GG50)
6	GASKETS	EPDM
7	ACTUATING LOAF	MS58
8	SHAFT	X20CM3
9	OUTLET OPENING	ALUMINIUM
10	SHAFT CAP	EN-GJL-250 (GG25)
11	BOLT AND LOAFS	8.8 GALVANIZED
12	RELIEF VALCE	MS58

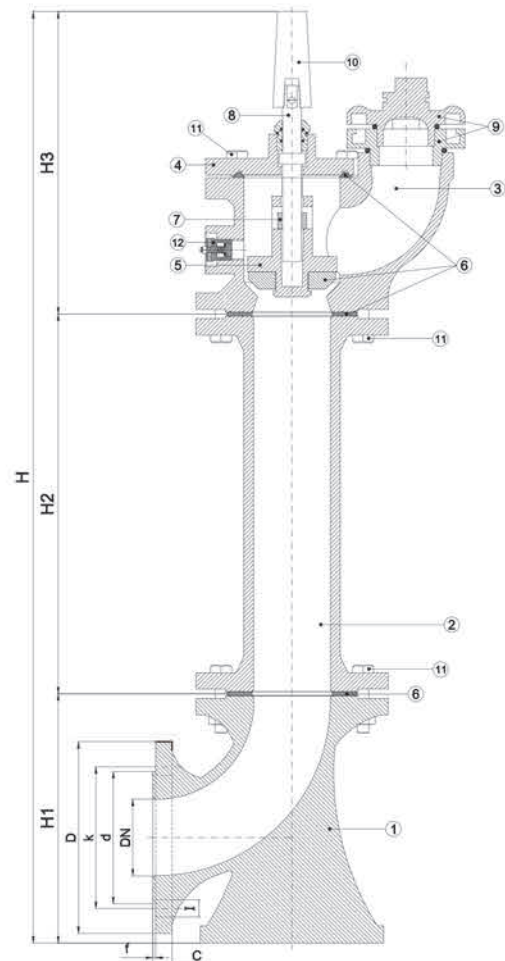

UNDERGROUND FIRE HYDRANT

TSEN 14339

These are hydrants of which water intake structure is below ground in compressed water network and cover is located above ground. Hydrant consists of Shaft which controls hydrant valve, cast parts which form housing and hose connections. Open and close operations for hydrant are made by controlling shaft by key. Underground fire hydrants are used for providing water for fire brigade in factories, warehouses, industrial plants, around of building, forest area which are sensitive against fire and residence areas.

FLANGE DIMENSION TABLE						
DN (RATED DIAMETER) (mm)	D (mm)	k (mm)	d (mm)	f (mm)	C (mm)	I hole diameter and quantity
80	200	160	132	3	22	Ø19x8 piece
100	220	180	156	3	24	piece

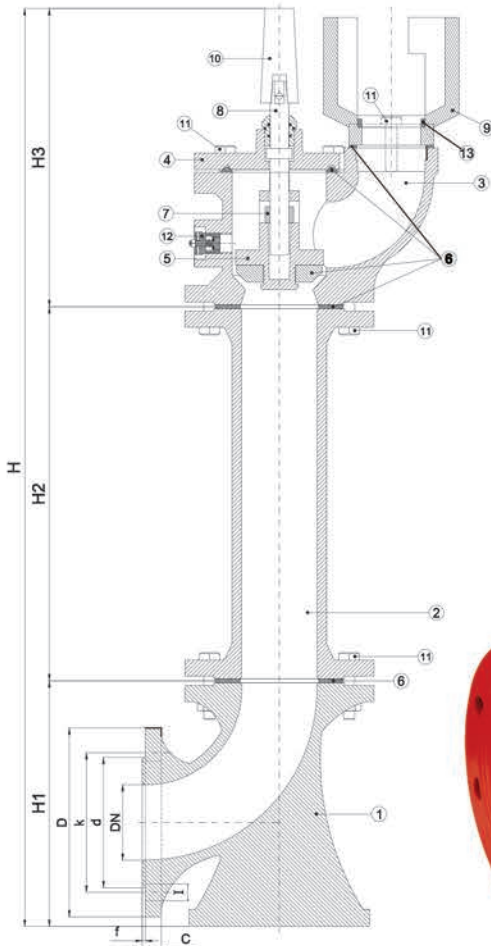

UNDERGROUND FIRE HYDRANT DIMENSION TABLE					
DN (mm) (RATED DIAMETER)	H1(mm)	H2(mm)	H3(mm)	H(mm)	WEIGHT(mm)
80	267	396	315	978	52
100	277	396	315	988	56

PARTS OF UNDERGROUND FIRE HYDRANT		
NO	NAME OF PART	MATERIAL
1	N PART HEEL	EN-GJL-250 (GG25) EN-GJS-400 (GGG40) EN-GJS-500 (GG50)
2	PIPE	EN-GJL-250 (GG25) EN-GJS-400 (GGG40) EN-GJS-500 (GG50)
3	UPPER HOUSING	EN-GJL-250 (GG25) EN-GJS-400 (GGG40) EN-GJS-500 (GG50)
4	COVER	EN-GJL-250 (GG25) EN-GJS-400 (GGG40) EN-GJS-500 (GG50)
5	SLIDE	EN-GJL-250 (GG25) EN-GJS-400 (GGG40) EN-GJS-500 (GG50)
6	GASKETS	EPDM
7	ACTATION LOAF	MS58
8	SHAFT	X20Cr13
9	DOVETAIL	EN-GJL-250 (GG25) EN-GJS-400 (GGG40) EN-GJS-500 (GG50)
10	SHAFT CAP	EN-GJL-250 (GG25)
11	BOLTS AND LOAF	8.8 GALVANIZED
12	RELEASE VALVE	MS58
13	DOVETAIL	MS58

N PART

It is heeled elbow for preventing pipe which connects fire hydrant with network to be bent and broken

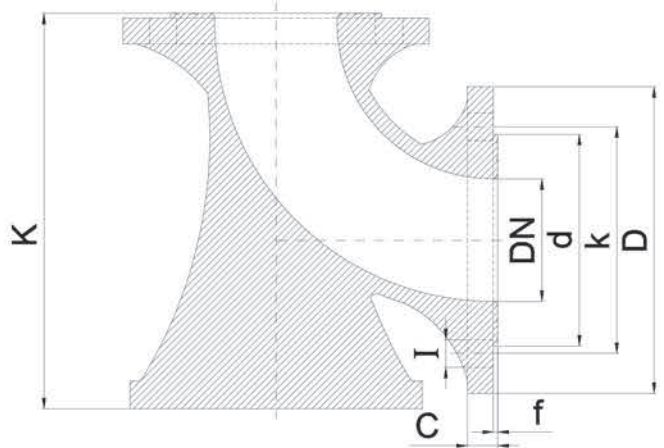

DIMENSION TABLE								
DN (RATED DIAMETER) (mm)	D (mm)	k (mm)	d (mm)	f (mm)	C (mm)	I Hole diameter and quantity	K (mm)	WEIGHT (Kg)
ø80	200	160	138	3	20	019x8 pieces	265	13
ø100	220	180	158	3	20	019x8 pieces	275	16

UNDERGROUND BOILER HYDRANT

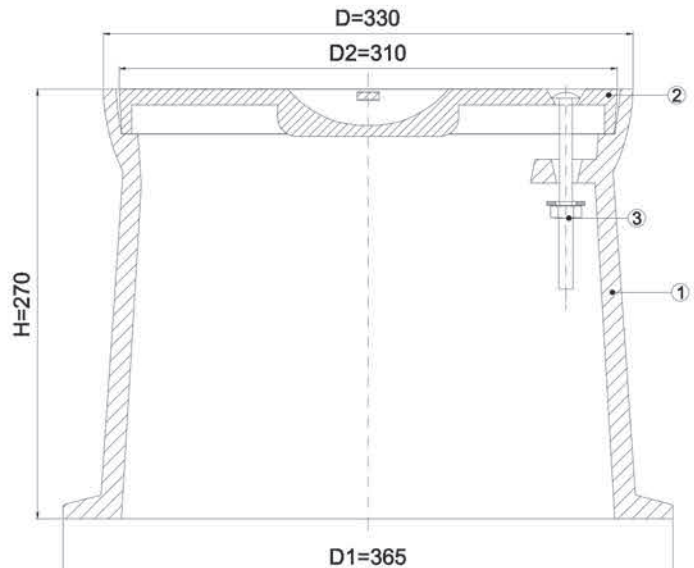

UNDERGROUND BOILER HYDRANT PARTS			
NO	NAME OF PART	MATERIAL	WEIGHT
			(Kg)
1	BOILER BODY	EN-GJL-250 (GG25) EN-GJS-400 (GGG40) EN-GJS-500 (GGG50)	23
2	BOILER COVER	EN-GJS-400 (GGG40) EN-GJS-500 (GGG50)	
3	COVER JOINT BOLT-LOAF	6.8 BOLT-LOAF	

TSEK ÜBM-00-BK-000

IMPACT FREE DYNAMIC VACUUM LIFTER

Task of vacuum lifters is to discharge all air inside pipelines and not to give harm to system while performing this. Most important problems regarding with ball vacuum lifters is to close before completely discharging air inside pipeline, deformation of ball inside vacuum lifter in time and fail to function properly.

Impact free dynamic vacuum lifters are vacuum lifters which provide system to work more efficiently and eliminates both problems.

Impact free dynamic vacuum lifter which works automatically designed with small volume, small weight. It ensures discharge of great air mass during filling big floated pipe line. Small floated releases small amount of air while pipeline is operated under pressure. Two staged closure design ensures impact free closing. It has longevity against corrosion due to High release capacity, stainless steel interior accessories

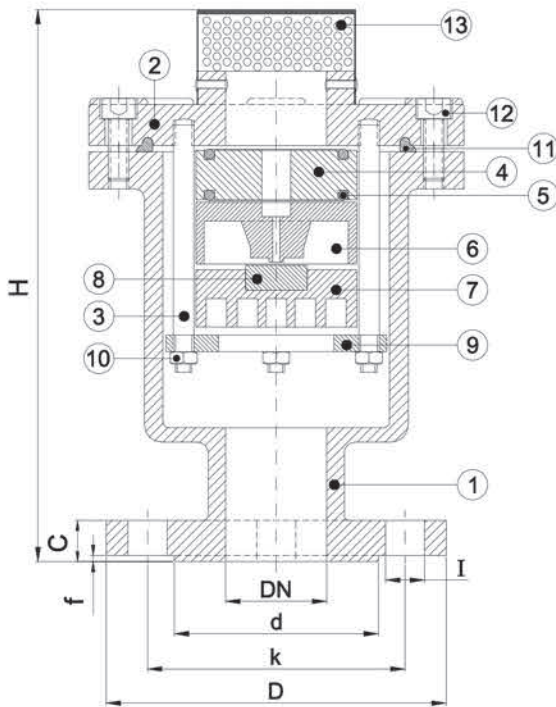

PARTS OF IMPACT FREE DYNAMIC VACUUM LIFTER

NO	NAME OF PART	MATERIAL
1	HOUSING	EN-GJS-400 (GGG40) EN-GJS-500 (GGG50)
2	COVER	EN-GJS-400 (GGG40) EN-GJS-500 (GGG50)
3	FLOATER CAGE SHAFT	420 STAINLESS
4	SMALL FLOATER	POLYETHYLENE
5	FLOATER O RING	EPDM
6	DYNAMIC FLOATER	POLYETHYLENE
7	GREATER FLOATER	POLYETHYLENE
8	BIGGER FLOATER GASKET	EPDM
9	FLOATER RING	POLYETHYLENE
10	F.CAGE SHAFT LOAF	A2/304 STAINLESS
11	COVER GASKET	EPDM
12	COVER BOLT	A2/304 STAINLESS
13	AIR RELIEVE FILTER	STAINLESS STEEL

IMPACT FREE DYNAMIC VACUUM LIFTER DIMENSION TABLE

DN (RATED DIAMETER) (mm)	D (mm)	k (mm)	d (mm)	f (mm)	c (mm)	I Hole diameter and quantity	H (mm)	WEIGHT (kg)
050 (PN10-16-25)	165	125	99	3	20	019x4 pieces	267	11
065 (PN 10-16-25)	185	145	118	3	20	019x4 pieces	267	11,5
080 (PN 10-16-25)	200	160	132	3	22	019x8 pieces	310	17
0100 (PN10-16)	220	180	156	3	24	019x8 pieces	324	24,5
0100 (PN25)	235	190	156	3	28	023x8 pieces	328	26
0125 (PN10-16)	250	210	184	3	26	019x8 pieces	326	25
0125 (PN25)	270	220	184	3	30	028x8 pieces	330	28
0150 (PN10-16)	285	240	211	3	26	023x8 pieces	422	45
0150 (PN25)	300	250	211	3	34	028x8 pieces	430	48
0200 (PN10)	340	295	266	4	26	023x8 pieces	487	70
0200 (PN16)	340	295	266	4	30	023x12 pieces	491	70
0200 (PN25)	360	310	274	4	34	028x12 pieces	495	75

DOUBLE BALL VACUUM LIFTER

TSEK ÜBM-00-BK-000

Air accumulations which occur particularly in pump outlets when water is delivered to pump outlets and pipe lines and makes water flow area narrower and causes decrease in capacity. Double ball vacuum lifters are used for preventing this adverse issue and in locations where high efficiency is required. Air which occurs when water is delivered to system firstly fills into vacuum lifter and discharged through holes which are located at inner side covers. Then water fills into vacuum lifter and lifts ball up and holes are closed and sealing is maintained.

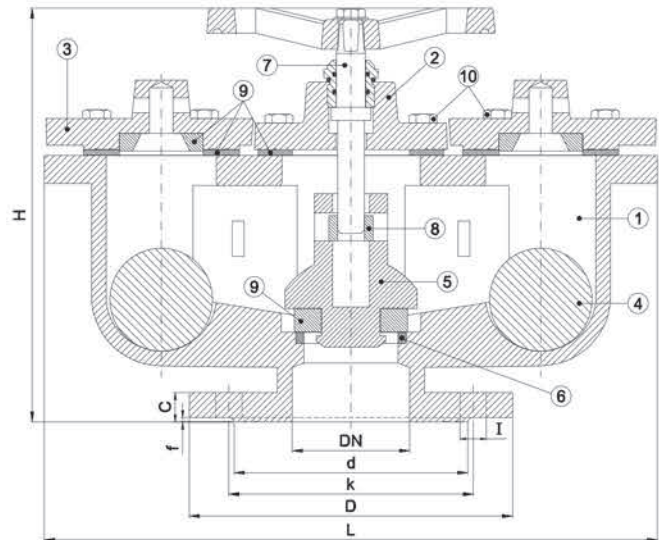

DOUBLE BALL VACUUM LIFTER DIMENSION TABLE									
DN (RATED DIAMETER)	D	k	d	f	C	I Hole diameter and quantity	L	H	WEIGHT
(mm)	(mm)	(mm)	(mm)	(mm)	(mm)		(mm)	(mm)	(Kg)
050 (PN10-16-25)	165	125	99	3	20	019x4 pieces	410	275	27
065 (PN 10-16-25)	185	145	118	3	20	019x4 pieces	410	275	28
080 (PN 10-16-25)	200	160	132	3	22	019x8 pieces	415	280	29
0100 (PN10-16)	220	180	156	3	24	019x8 pieces	415	280	31
0100 (PN25)	235	190	156	3	28	023x8 pieces	415	284	34
0125 (PN10-16)	250	210	184	3	26	019x8 pieces	415	280	32
0125 (PN25)	270	220	184	3	30	028x8 pieces	415	284	35
0150 (PN10-16)	285	240	211	3	26	023x8 pieces	635	400	79
0150 (PN25)	300	250	211	3	34	028x8 pieces	635	408	87
0200 (PN10)	340	295	266	4	26	023x8 pieces	635	400	87
0200 (PN16)	340	295	266	4	30	023x12 pieces	635	404	87
0200 (PN25)	360	310	274	4	34	028x12 pieces	635	408	95
0250 (PN10)	395	350	319	4	28	023x12 pieces	655	370	92
0250 (PN16)	405	355	319	4	32	028x12 pieces	655	374	93
0250 (PN25)	425	370	330	4	36	031x12 pieces	655	378	101

PARTS OF DOUBLE BALL VACUUM LIFTER		
NO	NAME OF PART	MATERIAL
1	HOUSING	EN-GJS-400 (GGG40) EN-GJS-500 (GGG50)
2	CENTRAL COVER	EN-GJS-400 (GGG40) EN-GJS-500 (GGG50)
3	SIDE COVER	EN-GJS-400 (GGG40) EN-GJS-500 (GGG50)
4	BALL	POLYETHYLENE
5	SLIDE	EN-GJS-400 (GGG40) EN-GJS-500 (GGG50)
6	BUSHING	MS58
7	SHAFT	X20Cr13
8	ACTUATING BOL	MS58
9	GASKETS	EPDM
10	BOLTS	8.8 GALVANIZED

TSEK ÜBM-00-BK-000

SINGLE BALL VACUUM LIFTER

Air accumulations which occur particularly in pump outlets when water is delivered to pump outlets and pipe lines and makes water flow area narrower and causes decrease in capacity. Single ball vacuum lifters are used for preventing this adverse issue and in locations where high efficiency is required. Air which occurs when water is delivered to system firstly fills into vacuum lifter and discharged through holes which are located at inner side covers. Then water fills into vacuum lifter and discharges through holes which are located at inner side covers. Then water fills into vacuum lifter and lifts ball up and holes are closed and sealing is maintained.

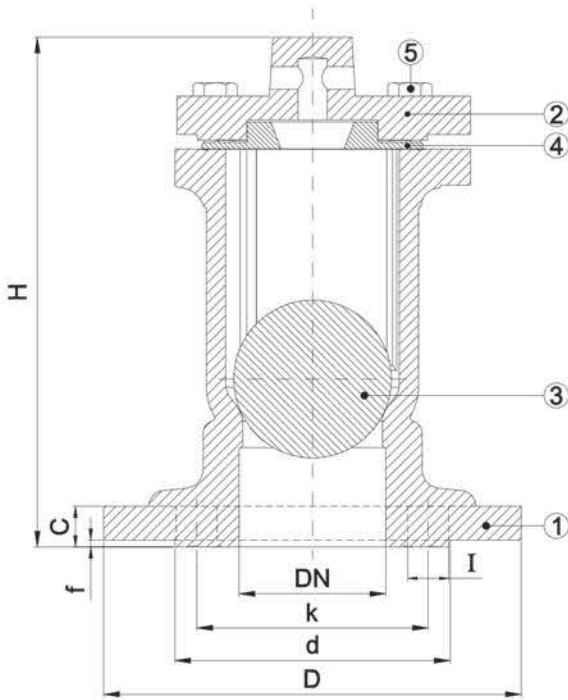

SINGLE BALL VACUUM LIFTER PARTS		
NO	NAME OF PART	MATERIAL
1	HOUSING	EN-GJS-400 (GGG40) EN GJS-500 (GGG50)
2	COVER	EN-GJS-400 (GGG40) EN GJS-500 (GGG50)
3	BALL	POLYETHYLEN
4	COVER GASKET	EPDM
5	COVER BOLT	8.8 GALVANIZED

SINGLE BALL VACUUM LIFTER DIMENSION TABLE								
DN (RATED DIAMETER) (mm)	D	k	d	f	C	I Hole diameter and quantity	H	WEIGHT
	(mm)	(mm)	(mm)	(mm)	(mm)		(mm)	(Kg)
050 (PN10-16-25)	165	125	99	3	20	019x4 pieces	227	8
065 (PN10-16-25)	185	145	118	3	20	019x4 pieces	229	9
080 (PN10-16-25)	200	160	132	3	22	019x8 pieces	236	13
0100 (PN10-16)	220	180	156	3	24	019x8 pieces	236	15
0100 (PN25)	235	190	156	3	28	023x8 pieces	240	14
0125 (PN10-16)	250	210	184	3	26	019x8 pieces	372	26
0125 (PN25)	270	220	184	3	30	028x8 pieces	376	28
0150 (PN10-16)	285	240	211	3	26	023x8 pieces	372	27
0150 (PN25)	300	250	211	3	34	028x8 pieces	380	29,5
0200 (PN10)	340	295	266	4	26	023x8 pieces	372	30
0200 (PN16)	340	295	266	4	30	023x12 pieces	376	30
0200 (PN25)	360	310	274	4	34	028x12 pieces	380	33

SWINGING CHECKVALVE (BALLED)

These are products which allow liquid to flow at flow direction and used for preventing flow at reverse direction. It prevents fluid back flow when pump is out of service in pump plants. Ball is closed by its own weight or counter force. Check valves are mounted considering the fluid flow direction. Ball system deforms late with respect to flap system. In the event that it is deformed, upper cover is opened and ball is removed and new one is installed and maintenance of checkvalve is made easily. It can be used easily in drinking water plants and fluids which are free of acid.

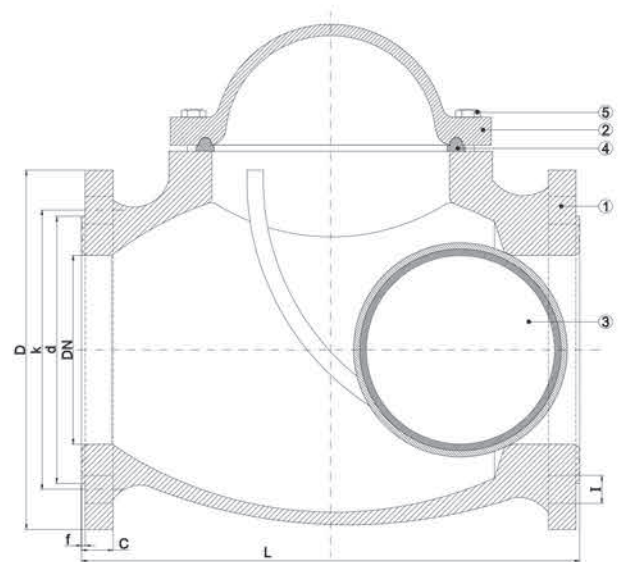

BALL CHECKVALVE DIMENSION TABLE

DN (RATED DIAMETER) (mm)	D (mm)	k (mm)	d (mm)	f (mm)	c (mm)	I Hole diameter and Quantity	L (mm)	WEIGHT (Kg)
050 (PN10-16-25)	165	125	99	3	20	019x4 piece	200	13
065 (PN10-16-25)	185	145	118	3	20	019x4 piece	240	18
080 (PN10-16-25)	200	160	132	3	22	019x8 piece	260	23
0100 (PN10-16)	220	180	156	3	24	019x8 piece	300	27
0100 (PN25)	235	190	156	3	28	023x8 piece	300	27
0125 (PN10-16)	250	210	184	3	26	019x8 piece	350	40
0125 (PN25)	270	220	184	3	30	028x8 piece	350	44
0150 (PN10-16)	285	240	211	3	26	023x8 piece	400	55
0150 (PN25)	300	250	211	3	34	028x8 piece	400	60
0200 (PN10)	340	295	266	4	26	023x8 piece	500	90
0200 (PN16)	340	295	266	4	30	023x12 piece	500	90
0200 (PN25)	360	310	274	4	34	028x12 piece	500	99
0250 (PN10)	395	350	319	4	28	023x12 piece	600	140
0250 (PN16)	405	355	319	4	32	028x12 piece	600	140
0250 (PN25)	425	370	330	4	36	031x12 piece	600	154

PARTS OF BALL CHECKVALVE

NO	NAME OF PART	MATERIAL
1	HOUSING	EN-GJS-400 (GGG40) EN-GJS-500 (GGG50)
2	COVER	EN-GJS-400 (GGG40) EN-GJS-500 (GGG50)
3	BALL	EN-GJS-400-500 (GGG40-50) + EPDM COATED
4	COVER GASKET	EPDM
5	COVER BOLTS	8.8 GALVANIZED

SWING CHECK VALVE

These are products which allow fluid to flow at flow direction and used for preventing flow of fluid at reverse direction. It prevents back flow of fluid when pump is out of service in pump plant. Flap is closed by its own weight or counter force. Check valves should be installed by considering flow direction of fluid. Maintenance of system is made by opening upper cover and easily removing flap with swinging system and replacing with new one. It can be used easily in hot and cold water plants, drinking water network and fluids which are free of acid.

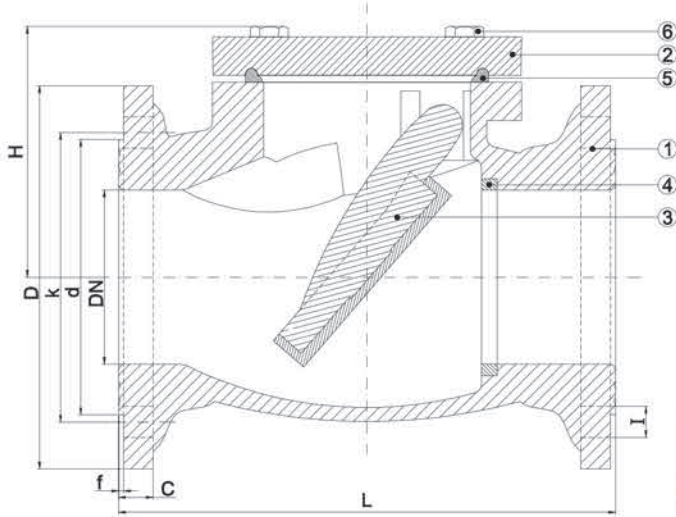

PARTS OF SWING CHECKVALVE		
NO	NAME OF PART	MATERIAL
1	HOUSING	EN-GJS-400 (GGG40) EN-GJS-500 (GGG50)
2	COVER	EN-GJS-400 (GGG40) EN-GJS-500 (GGG50)
3	FLAP	EN-GJS-400-500 (GGG40-50) + EPDM KAPLI
4	BUSHING	MS58
5	COVER GASKET	EPDM
6	COVER BOLTS	8.8 GALVANIZED

DIMENSION TABLE FOR SWING CHECKVALVE									
DN (RATED DIAMETER) (mm)	D (mm)	k (mm)	d (mm)	f (mm)	C (mm)	hole diameter and quantity	L (mm)	H (mm)	WEIGHT (Kg)
050 (PN10-16-25)	165	125	99	3	20	019x4 pieces	200	124	13
065 (PN10-16-25)	185	145	118	3	20	019x4 pieces	240	153	18
080 (PN10-16-25)	200	160	132	3	22	019x8 pieces	260	150	23
0100 (PN10-16)	220	180	156	3	24	019x8 pieces	300	144	27
0100(PN25)	235	190	156	3	28	023x8 pieces	300	144	27
0125 (PN10-16)	250	210	184	3	26	019x8 pieces	350	165	40
0125(PN25)	270	220	184	3	30	028x8 pieces	350	165	44
0150 (PN10-16)	285	240	211	3	26	023x8 pieces	400	198	55
0150(PN25)	300	250	211	3	34	028x8 pieces	400	198	60
0200(PN10)	340	295	266	4	26	023x8 pieces	500	227	90
0200(PN16)	340	295	266	4	30	023x12 pieces	500	227	90
0200(PN25)	360	310	274	4	34	028x12 pieces	500	227	99
0250(PN10)	395	350	319	4	28	023x12 pieces	600	240	140
0250(PN16)	405	355	319	4	32	028x12 pieces	600	240	140
0250(PN25)	425	370	330	4	36	031x12 pieces	600	240	154
0300 (PN10)	445	400	370	4	28	023x12 pieces	700	245	190
0300 (PN16)	460	410	370	4	32	028x12 pieces	700	245	190
0300 (PN25)	485	430	389	4	40	031x16 pieces	700	245	209

BUTTERFLY VALVE WITH ACTUATOR

TSEN 593

Valve was designed such that it will present minimum resistance for valve housing and flaps. Sealing is maintained by T section sealing ring which is fixed with fixed by peripheral press ring next to flap. Sealing is maintained certainly at both direction since sealing ring presses over housing seat which was processed conically when flap is closed positions. Sealing ring can be replaced easily without requiring to dismantle the flap. Seat surface is resistant against abrasion and corrosion since it was manufactured from hard chromium or AISI 316 Stainless steel welding filler. Our butterfly valves are manufactured as double eccentric. Aim of first eccentric is to lower pressure which is present over rubber sealing ring when valve is opened, removal of corrosive effect and maintaining continuous contact between sealing ring and housing seat. During opening process, rubber sealing easily disconnects from housing seat surface by means for second eccentric. There is design for Double parted shaft which increases passage section. Valves are maintained to have longevity without requiring maintenance for the valves by O-ring system which is built over self lubricating sleeves which are made of brass and delrin.

Gearbox maintains quarter tour (90 degrees) movement which is required by butterfly valves. Gearboxes are designed such that they will ensure butterfly valves to be opened by one person under rated pressure by rotating flywheel manually. It is lockable type and it does not allow forces which influence flap due to flow conditions to rotate flap. Outlets of gearboxes are manufactured to be suitable for installation of any kind of electrical actuators.

DESIGN: They are manufactured accordingly with TS EN 592

Connection Length: TS EN 558*1

Flange Connections: EN 1092-2; ISO 7005-2

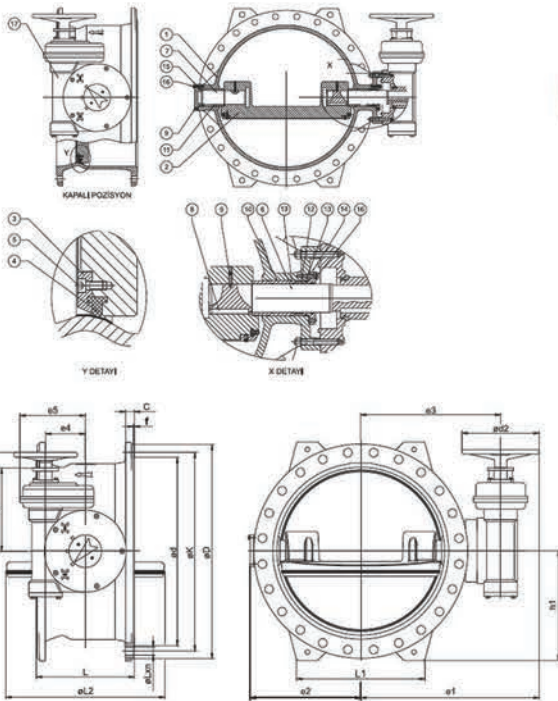

DN	PN	L Sen14	L1	L2	e1	e2	e3	e4	e5	d2	h1	h2	h3	Weight (kg)
100	10	190	-	100	316	115	200	65	113	200	115	114	164	30
125	10	200	-	126	348	134	228	65	113	200	130	114	164	35
150	10	210	-	152	378	151	255	71	134	240	143	136	212	45
200	10	230	180	199	405	177	282	71	134	240	180	136	212	60
250	10	250	220	251	481	214	352	95	158	240	213	163	239	75
300	10	270	280	281	503	237	380	95	158	240	242	163	239	105
350	10	290	320	336	595	283	410	110	175	320	264	184	271	155
400	10	310	335	385	626	297	441	110	175	320	293	184	271	190
450	10	330	380	434	670	333	485	110	198	320	320	285	372	220
500	10	350	400	474	701	344	516	156	245	320	345	334	420	230
600	10	390	440	576	749	414	564	156	245	320	400	334	420	380
700	10	430	540	671	838	511	653	190	313	320	460	397	484	510
750	10	450	580	710	882	542	697	190	313	320	496	397	484	630
800	10	470	610	766	855	530	970	190	313	320	520	397	484	650
900	10	510	670	861	965	618	780	242	365	320	568	432	519	800
1000	10	550	740	951	1039	650	854	242	365	320	625	432	519	1120
1100	10	590	750	1053	1022	720	837	242	365	320	695	432	519	1560
1200	10	630	900	1147	1251	782	1008	290	515	400	738	538	625	1820
1300	10	670	988	1248	1301	867	1059	290	515	400	803	538	625	2870
1400	10	710	1160	1345	1349	917	1101	290	515	400	848	538	625	3100
1500	10	750	1080	1435	1411	1015	1168	431	656	400	910	681	768	3450
1600	10	790	1250	1537	1483	1060	1240	431	656	400	970	681	768	4360
1800	10	870	1220	1722	1586	1183	1343	431	656	485	107	681	768	4760
2000	10	950	1300	1901	1769	1303	1526	431	656	485	118	681	768	7180
2200	10	1030	1500	2085	1906	1420	1603	431	656	605	128	809	909	8310
2400	10	1110	1600	2308	2095	1593	1792	519	744	605	139	898	998	12700
2500	10	1150	1600	2396	2122	1610	1819	519	744	605	144	898	998	13900

NO	PART NAME	DERAILS
1	Housing	Nodular casting EN-GJS-400-15
2	Flap	Nodular casting EN-GJS-400-15
3	Sealing ring	Steel S235JR
4	Sealing ring	EPDM
5	Imbus bolt	Stainless steel A2
6	Drive shaft	Stainless steel X20CR13
7	Release shaft	Stainless steel X20CR13
8	Wedge	Steel Ck45
9	Set screw	Stainless steel A2
10	Bed bushing	Brass
11	Bed bushing	Brass
12	Nose bushing	Delrin
13	O-Ring	EPDM
14	Drive shaft cover	Nodular casting EN-GJS-400-15
15	Release shaft cover	Nodular casting EN-GJS-400-15
16	Hexagon headed bolt	Stainless steel A2
17	Gearbox	-

MANUALLY CONTROLLED BUTTERFLY VALVE

TSEN 593

Valve was designed such that it will present minimum resistance for valve housing and flaps. Sealing is maintained by T section sealing ring which is fixed with fixed by peripheral press ring next to flap. Sealing is maintained certainly at both direction since sealing ring presses over housing seat which was processed conically when flap is closed positions. Sealing ring can be replaced easily without requiring to dismantle the flap. Seat surface is resistant against abrasion and corrosion since it was manufactured from hard chromium or AISI 316 Stainless steel welding filler. Our butterfly valves are manufactured as double eccentric. Aim of first eccentric is to lower pressure which is present over rubber sealing ring when valve is opened, removal of corrosive effect and maintaining continuous contact between sealing ring and housing seat. During opening process, rubber sealing easily disconnects from housing seat surface by means for second eccentric. There is design for Double parted shaft which increases passage section. Valves are maintained to have longevity without requiring maintenance for the valves by O-ring system which is built over self lubricating sleeves which are made of brass and delrin. Gearbox maintains quarter tour (90 degrees) movement which is required by butterfly valves. Gearboxes are designed such that they will ensure butterfly valves to be opened by one person under rated pressure by rotating flywheel manually. It is lockable type and it does not allow forces which influence flap due to flow conditions to rotate flap. Outlets of gearboxes are manufactured to be suitable for installation of any kind of electrical actuators.

DESIGN: They are manufactured accordingly with TS EN 592

Connection Length: TS EN 558*1

Flange Connections: EN 1092-2; ISO 7005-2

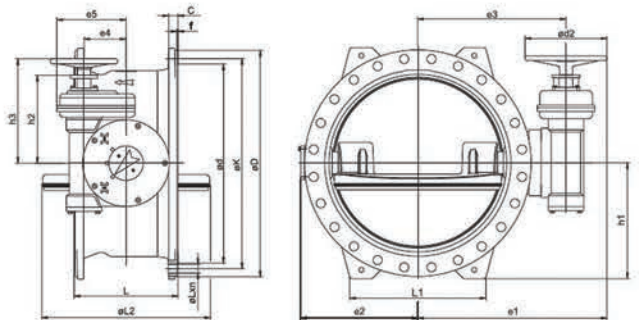
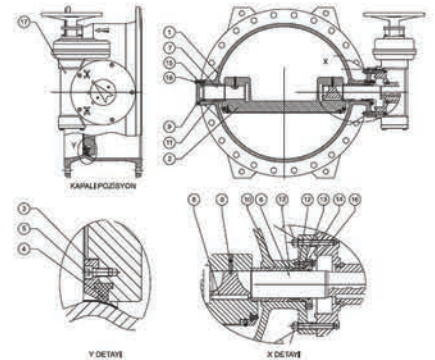
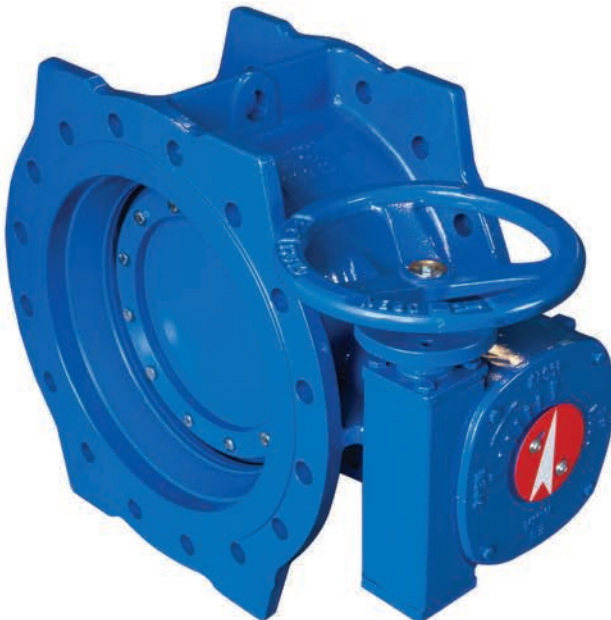

NO	PART NAME	DETAILS
1	Housing	Nodular casting EN-GJS-400-15
2	Flap	Nodular casting EN-GJS-400-15
3	Sealing ring	Steel S235JR
4	Sealing ring	EPDM
5	Imbus bolt	Stainless steel A2
6	Drive shaft	Stainless steel X20CR13
7	Release shaft	Stainless steel X20CR13
8	Wedge	Steel Ck45
9	Set screw	Stainless steel A2
10	Bed bushing	Brass
11	Bed bushing	Brass
12	Nose bushing	Delrin
13	O-Ring	EPDM
14	Drive shaft cover	Nodular casting EN-GJS-400-15
15	Release shaft cover	Nodular casting EN-GJS-400-15
16	Hexagon headed bolt	Stainless steel A2
17	Gearbox	-

DN	PN	L Ser14	L1	L2	e1	e2	e3	e4	e5	d2	h1	h2	h3	Weight (kg)
100	10	190	-	100	316	115	200	65	113	200	115	114	164	30
125	10	200	-	126	348	134	228	65	113	200	130	114	164	35
150	10	210	-	152	378	151	255	71	134	240	143	136	212	45
200	10	230	180	199	405	177	282	71	134	240	180	136	212	60
250	10	250	220	251	481	214	352	95	158	240	213	163	239	75
300	10	270	280	281	503	237	380	95	158	240	242	163	239	105
350	10	290	320	336	595	283	410	110	175	320	264	184	271	155
400	10	310	335	385	626	297	441	110	175	320	293	184	271	190
450	10	330	380	434	670	333	485	110	198	320	320	285	372	220
500	10	350	400	474	701	344	516	156	245	320	345	334	420	230
600	10	390	440	576	749	414	564	156	245	320	400	334	420	380
700	10	430	540	671	838	511	653	190	313	320	460	397	484	510
750	10	450	580	710	882	542	697	190	313	320	496	397	484	630
800	10	470	610	766	855	530	970	190	313	320	520	397	484	650
900	10	510	670	861	965	618	780	242	365	320	568	432	519	800
1000	10	550	740	951	1039	650	854	242	365	320	625	432	519	1120
1100	10	590	750	1053	1022	720	837	242	365	320	695	432	519	1560
1200	10	630	900	1147	1251	782	1008	290	515	400	738	538	625	1820
1300	10	670	988	1248	1301	867	1059	290	515	400	803	538	625	2870
1400	10	710	1160	1345	1349	917	1101	290	515	400	848	538	625	3100
1500	10	750	1080	1435	1411	1015	1168	431	656	400	910	681	768	3450
1600	10	790	1250	1537	1483	1060	1240	431	656	400	970	681	768	4360
1800	10	870	1220	1722	1586	1183	1343	431	656	485	107	681	768	4760
2000	10	950	1300	1901	1769	1303	1526	431	656	485	118	681	768	7180
2200	10	1030	1500	2085	1906	1420	1603	431	656	605	128	809	909	8310
2400	10	1110	1600	2308	2095	1593	1792	519	744	605	139	898	998	12700
2500	10	1150	1600	2396	2122	1610	1819	519	744	605	144	898	998	13900

TILTING CHECKVALVE

Short housing, low volume and low weight. Shafts which extent at both sides of checkvalves, counterweight and lever facilitates pipe installation vertically or horizontally at left and right side of checkvalve . Flap moves freely according to flows. Opening flap depends of flow rate. Weight of which position can be adjusted adapts with operational conditions. Maintenance free design which does not require metal to metal or rubber sealingdesign

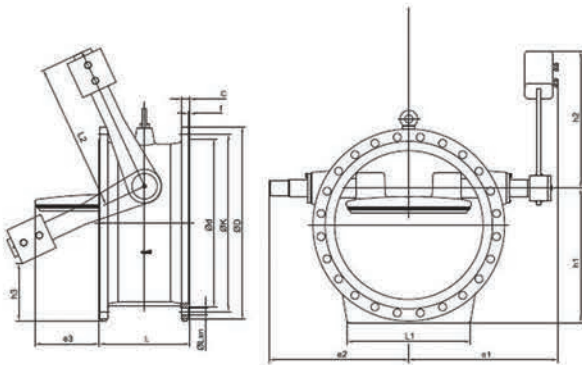
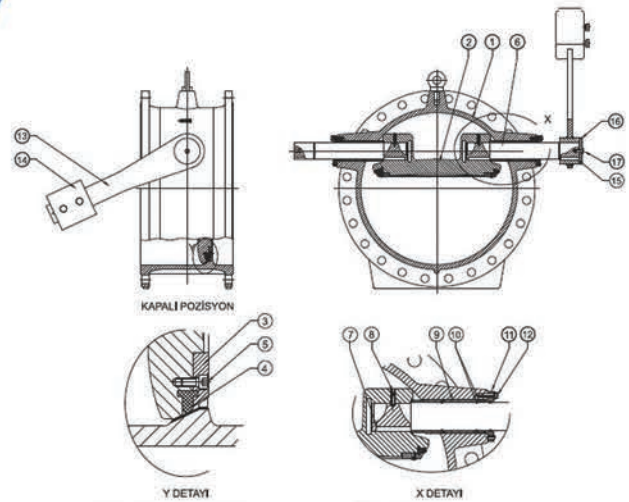
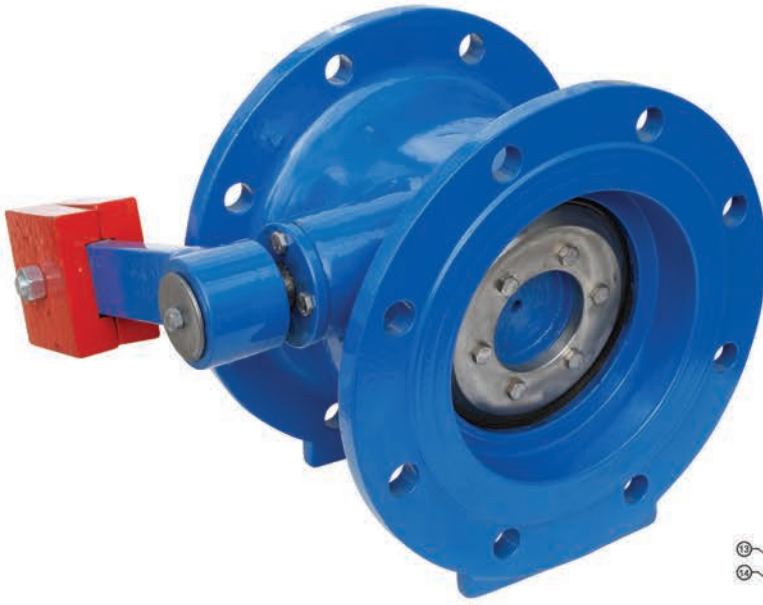

DN	PN	L	L2	e1	e2	e3	h1	h2	h3	Weight (kg)
200	10	230	200	268	252	35	220	188	107	50
250	10	250	300	325	305	68	265	285	92	70
300	10	270	300	340	317	87	315	285	142	105
350	10	290	400	410	382	117	357	372	140	170
400	10	310	400	440	412	138	400	372	182	220
450	10	330	450	470	443	165	442	418	204	275
500	10	350	500	520	490	188	470	465	200	320
600	10	390	600	590	567	238	580	555	267	440
700	10	430	700	700	661	305	640	653	273	560
800	10	470	800	745	711	355	723	743	314	810
900	10	510	900	800	780	400	797	830	348	1100
1000	10	550	1000	870	863	460	887	935	360	1220

NO	NAME OF PART	MATERIAL
1	Housing	Nodule casting EN-GJS-400-15
2	Flap	Nodule casting EN-GJS-400-15
3	Press ring	Steel S235JR
4	Sealing ring	EPDM
5	imbus bolt	Stainless Steel A2
6	Shaft	Stainless Steel X20CR13
7	Wedge	Steel Ck45
8	Set screw	Stainless Steel A2
9	Bearing bushing	Brass
10	O-Ring	EPDM
10	Cover	Nodule casting EN-GJS-400-15
12	Hexagon headed bolt	Stainless Steel A2
13	Lever	Steel S235JR
14	Weight	Steel S235JR
15	Wedge	Steel Ck45
16	Cover	Steel S235JR
17	Hexagon headed boly	Stainless Steel A2

DISMANTLING PART

It is used for all piped systems for facilitating assembly and disassembly of flanged valves in all piped systems. It takes axial forces which are located over valves in pipelines and maintains dismantling easiness. Part of dismantling part is shortened +/- 400 mm during assembly and dismantling and necessary working area is created. Our dismantling parts are manufactured as semi rigid. If requested it can be manufactured as full rigid or telescopic type. Rigid type design dismantling parts allow installation without requiring additional bolt or loaf.

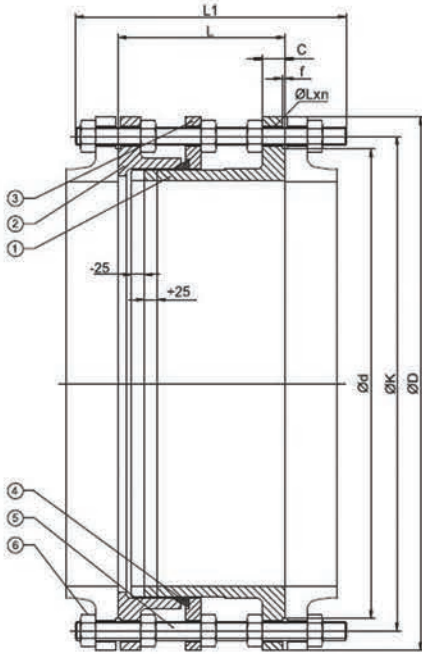

Rated Diameter DN	DIMENSIONS									
	PN 10			PN 16			H H	PN 10	PN 16	
	D	k	D	D	k	d2xn		kg	kg	
50	165	125	19x4	165	125	19x4	40	8	8	
65	185	145	19x4	185	145	19x4	40	9	9	
80	200	160	19x8	200	160	19x8	40	16	16	
100	220	180	19x8	220	180	19x8	40	21	21	
125	250	210	19x8	250	210	19x8	40	26	26	
150	285	240	23x8	285	240	23x8	40	35	35	
200	340	295	23x8	340	295	23x12	40	46	50	
250	400	350	23x12	405	355	28x12	40	70	80	
300	455	400	23x12	460	410	28x12	40	90	99	
350	505	460	23x16	520	470	28x16	40	105	140	
400	565	515	28x16	580	525	31x16	40	135	165	
450	615	565	28x20	640	585	31x20	40	145	190	
500	670	620	28x20	715	650	34x20	40	155	210	
600	780	725	31x20	840	770	37x20	40	215	300	
700	895	840	31x24	910	840	37x24	40	265	340	
800	1015	950	34x24	1025	950	41x24	40	310	400	
900	1115	1050	34x28	1125	1050	41x28	40	370	450	
1000	1230	1160	37x28	1255	1170	44x28	40	450	500	
1100	1340	1270	37x32	1355	1270	44x32	40	600	700	
1200	1455	1380	41x32	1485	1390	50x32	40	730	840	
1300	1585	1490	42x32	1585	1490	50x32	40	810	950	
1400	1675	1590	44x36	1685	1590	50x36	40	890	1020	
1500	1785	1700	44x36	1820	1710	57x36	40	1050	1250	
1600	1915	1820	50x40	1930	1820	57x40	40	1680	2100	
1800	2115	2020	50x44	2130	2020	57x44	40	2100	2800	
2000	2325	2230	50x48	2345	2230	62x48	40	2400	3050	

NO	NAME OF PART	Material EN-GJS-400-15
1	Long part	Nodule casting EN-GJS-400-15
2	Short part	Nodule casting EN-GJS-400-15
3	Pressing flange	Steel S235JR
4	Sealing ring	EPDM
5	Stud bolt	Steel-galvanized
6	Loaf	Steel-galvanized

**FOR PVC PIPES
G-mmB PIECES - FLANGED DOVETAILED T**

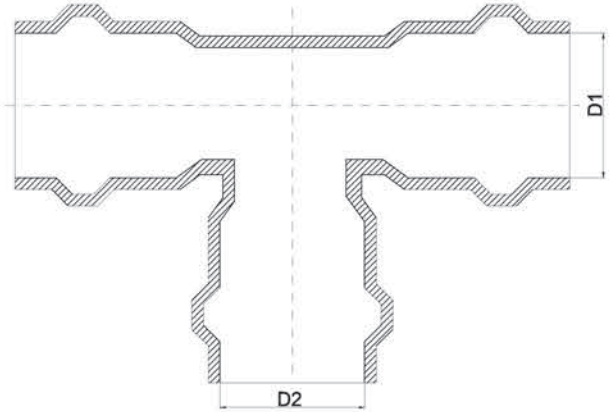

NORMAL DIA NW	D1/D2	WEIGHT KG
50/50	63/63	4,30
65/50	75/63	5,20
65/65	75/75	5,60
80/50	90/63	7,50
80/65	90/75	8,00
80/80	90/90	8,50
100/50	110/63	9,00
100/65	110/75	9,50
100/80	110/90	10,00
100/100	110/110	10,20
110/50	125/63	12,50
110/65	125/75	13,00
110/80	125/90	14,00
110/100	125/110	15,00
110/110	125/125	17,00
125/50	140/63	17,00
125/65	140/75	17,10
125/80	140/90	17,60
125/100	140/110	18,40
125/110	140/125	19,00
125/125	140/140	20,80
150/50	160/63	20,00
150/65	160/75	20,10
150/80	160/90	21,00
150/100	160/110	22,00
150/110	160/125	23,50
150/125	160/140	23,90
150/150	160/160	26,80
175/50	200/63	28,00
175/65	200/75	30,00
175/80	200/90	32,00
175/100	200/110	34,00
175/110	200/125	35,00
175/125	200/140	36,80
175/150	200/160	39,00

NORMAL DIA NW	D1/D2	WEIGHT KG
175/175	200/200	40,00
200/50	225/63	31,00
200/65	225/75	32,00
200/80	225/90	34,00
200/100	225/110	36,80
200/110	225/125	37,00
200/125	225/140	39,00
200/150	225/160	40,00
200/175	225/200	46,00
200/200	225/225	53,00
225/50	250/63	42,00
225/65	250/75	43,00
225/80	250/90	44,00
225/100	250/110	46,00
225/110	250/125	48,00
225/125	250/140	50,00
225/150	250/160	52,00
225/175	250/200	54,00
225/200	250/225	8,00
225/225	250/250	62,00
250/50	280/63	55,00
250/65	280/75	56,00
250/80	280/90	57,00
250/100	280/110	58,00
250/110	280/125	60,00
250/125	280/140	62,00
250/150	280/160	64,00
250/175	280/200	69,00
250/200	280/225	72,00
250/225	280/250	73,00
250/250	280/280	75,00
300/50	315/63	72,00
300/65	315/75	75,00
300/80	315/90	76,00
300/100	315/110	77,00

NORMAL DIA NW	D1/D2	WEIGHT KG
300/110	315/125	79,00
300/125	315/140	81,00
300/150	315/160	82,00
300/175	315/200	90,00
300/200	315/225	92,00
300/225	315/250	100,00
300/250	315/280	105,00
300/300	315/315	115,00
350/50	355/63	116,00
350/65	355/75	117,00
350/80	355/90	118,00
350/100	355/110	120,00
350/110	355/125	123,00
350/125	355/140	125,00
350/150	355/160	126,00
350/175	355/200	130,00
350/200	355/225	135,00
300/225	355/250	145,00
350/250	355/280	146,00
350/300	355/315	160,00
350/350	355/355	175,00
400/50	400/63	125,00
400/65	400/75	126,00
400/80	400/90	128,00
400/100	400/110	135,00
400/110	400/125	140,00
400/125	400/140	142,00
400/150	400/160	145,00
400/175	400/200	160,00
400/200	400/225	165,00
400/225	400/250	170,00
400/250	400/280	180,00
400/300	400/315	185,00
400/350	400/355	190,00
400/400	400/400	199,00

FOR PVC PIPES
G-mma PIECES - FLANGED DOVETAILED T



NORMAL DIA NW	D1/D2	WEIGHT KG
50/50	63/50	6,00
65/50	75/50	7,30
65/65	75/65	8,50
80/50	90/50	8,50
80/65	90/65	9,70
80/80	90/80	11,00
100/50	110/50	11,00
100/65	110/65	12,50
100/80	110/80	13,00
100/100	110/100	13,60
110/50	125/50	14,00
110/65	125/65	15,00
110/80	125/80	16,00
110/100	125/100	20,00
110/110	125/110	21,00
125/50	140/50	16,00
125/65	140/65	16,50
125/80	140/80	16,50
125/100	140/100	18,70
125/110	140/110	22,00
125/125	140/125	23,00
150/50	160/50	20,00
150/65	160/65	20,20
150/80	160/80	21,00
150/100	160/100	23,40
150/110	160/110	25,00
150/125	160/125	25,90
150/150	165/150	29,70
175/50	200/50	35,00
175/65	200/65	36,00
175/80	200/80	37,80
175/100	200/100	39,00
175/110	200/110	47,50
175/125	200/125	48,00
175/150	200/150	50,00
175/175	200/175	53,00
200/50	225/50	36,00
200/65	225/65	38,00
200/80	225/80	40,00
200/100	225/100	41,60
200/110	225/110	46,00
200/125	225/125	52,00
200/150	225/150	61,00
200/175	225/175	65,00
200/200	225/200	71,00
225/50	250/50	50,00
225/65	250/65	52,00
225/80	250/80	53,00
225/100	250/100	54,00
225/110	250/110	60,00
225/125	250/125	60,00

NORMAL DIA NW	D1/D2	WEIGHT KG
225/150	250/150	63,00
225/175	250/175	67,00
225/200	250/200	68,00
225/225	250/225	74,00
250/50	280/50	62,00
250/65	280/65	62,00
250/80	280/80	63,00
250/100	280/100	66,00
250/110	280/110	72,00
250/125	280/125	73,50
250/150	280/150	77,00
250/175	280/175	80,00
250/200	280/200	84,00
250/250	280/250	89,00
300/50	315/50	76,00
300/65	315/65	77,00
300/80	315/80	79,00
300/100	315/100	80,00
300/110	315/110	85,00
300/125	315/125	99,00
300/150	315/150	100,00
300/175	315/175	105,00
300/200	315/200	108,00
300/250	315/250	118,00
300/300	315/300	120,00
350/50	355/50	116,00
350/65	355/65	117,00
350/80	355/80	120,00
350/100	355/100	122,00
350/110	355/110	125,00
350/125	355/125	126,00
350/150	355/150	128,00
350/175	355/175	130,00
350/200	355/200	135,00
350/250	355/250	145,00
350/300	355/300	160,00
350/350	355/350	180,00
400/50	400/50	122,00
400/65	400/65	125,00
400/80	400/80	128,00
400/100	400/100	135,00
400/110	400/110	136,00
400/125	400/125	140,00
400/150	400/150	145,00
400/175	400/175	155,00
400/200	400/200	160,00
400/250	400/250	160,00
400/300	400/300	170,00
400/350	400/350	180,00
400/400	400/400	198,00

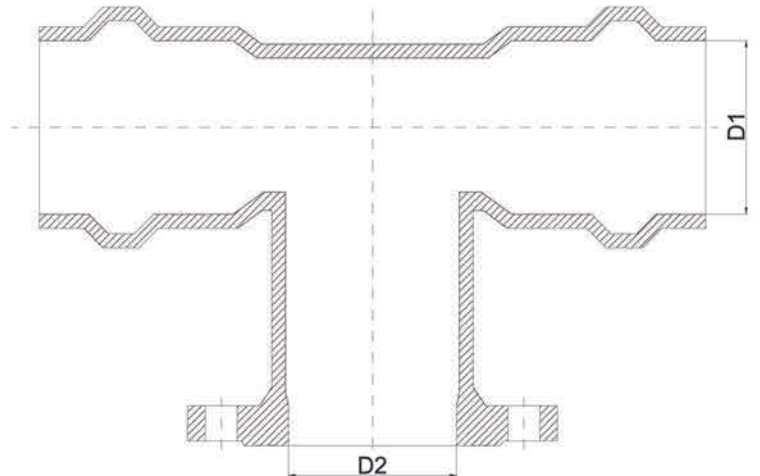

FOR PVC PIPES G-mmR PIECES DOVETAILED RECUTION

NORMINAL DIA NW	D / D1	WEIGHT KG	NORMINAL DIA NW	D / D1	WEIGHT KG
65 / 50	75 / 63	3,02	225 / 100	250 / 110	32,00
80 / 50	90 / 63	4,50	225 / 110	250 / 125	32,50
80 / 65	90 / 75	4,60	225 / 125	250 / 140	33,00
100 / 50	110 / 63	6,00	225 / 150	250 / 160	33,50
100 / 65	110 / 75	6,18	225 / 175	250 / 200	34,00
100 / 80	110 / 90	6,20	225 / 200	250 / 225	35,50
110 / 50	125 / 63	6,40	250 / 100	280 / 110	38,00
110 / 65	125 / 75	6,50	250 / 110	280 / 125	38,70
110 / 80	125 / 90	6,60	250 / 125	280 / 140	39,00
110 / 100	125 / 110	7,50	250 / 150	280 / 160	39,80
125 / 50	140 / 63	8,20	250 / 175	280 / 200	40,40
125 / 65	140 / 75	8,25	250 / 200	280 / 225	47,00
125 / 80	140 / 90	8,30	250 / 225	280 / 250	51,00
125 / 100	140 / 110	8,55	300 / 100	315 / 110	48,00
125 / 110	140 / 125	9,20	300 / 110	315 / 125	50,00
150 / 50	160 / 63	9,90	300 / 125	315 / 140	51,00
150 / 65	160 / 75	10,00	300 / 150	315 / 160	52,50
150 / 80	160 / 90	10,10	300 / 175	315 / 200	54,00
150 / 100	160 / 110	10,20	300 / 200	315 / 225	56,00
150 / 110	160 / 125	1,60	300 / 225	315 / 250	58,00
150 / 125	160 / 140	11,30	300 / 250	315 / 280	68,00
175 / 80	200 / 90	14,70	350 / 175	355 / 200	74,00
175 / 100	200 / 110	14,75	350 / 200	355 / 225	75,00
175 / 110	200 / 125	14,80	350 / 225	355 / 250	76,00
175 / 125	200 / 140	14,90	350 / 250	355 / 280	78,00
175 / 150	200 / 160	15,00	350 / 300	355 / 315	80,00
200 / 80	225 / 90	19,20	400 / 175	400 / 200	81,00
200 / 100	225 / 110	19,40	400 / 200	400 / 225	83,00
200 / 110	225 / 125	19,60	400 / 225	400 / 250	85,00
200 / 125	225 / 140	19,80	400 / 250	400 / 280	88,00
200 / 150	225 / 160	20,00	400 / 300	400 / 315	90,00
200 / 175	225 / 200	24,60	400 / 350	400 / 355	105,00

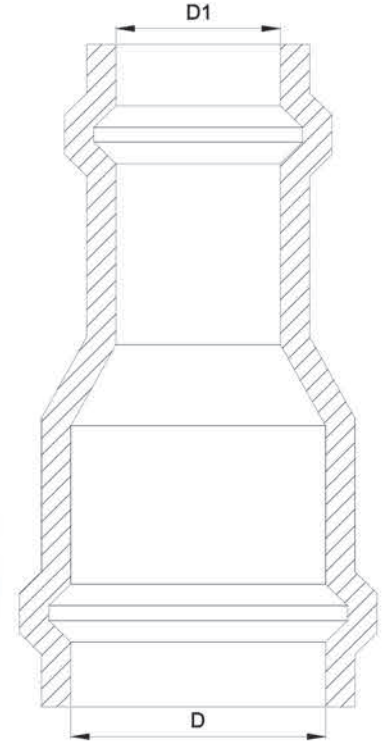

ACP-PVC TRANSITION PIECE

NORMINAL DIA NW	D1	D2	WEIGHT KG
50/60	63	78	3,10
65/80	75	98	4,70
80/80	90	98	4,50
100/100	110	120	7,00
110/125	125	149	12,70
125/125	140	149	13,60
150/150	160	176	14,50
175/200	200	234	25,00
200/200	225	234	25,00
225/250	250	288	34,00
250/250	280	288	38,00
300/300	315	344	56,00

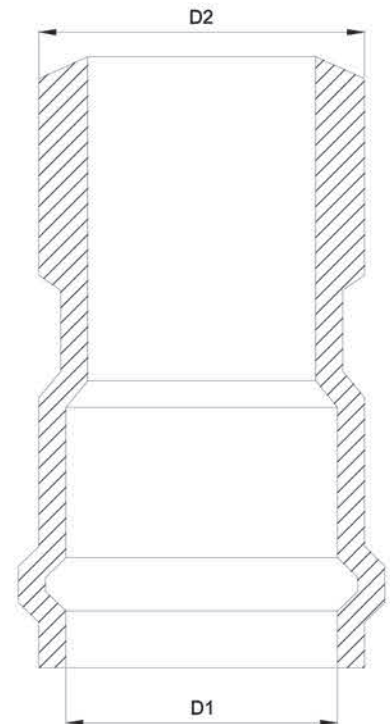

**FOR PVC PIPES
GE PIECES - FLANGED DOVETAILED E**

NORMAL DIA NW	D	WEIGHT KG
50	63	3,32
65	75	4,30
80	90	5,40
100	110	6,20
110	125	9,00
125	140	10,00
150	160	12,60
175	200	19,00
200	225	20,00
225	250	29,00
250	280	37,00
300	315	49,00
350	355	60,00
400	400	72,00

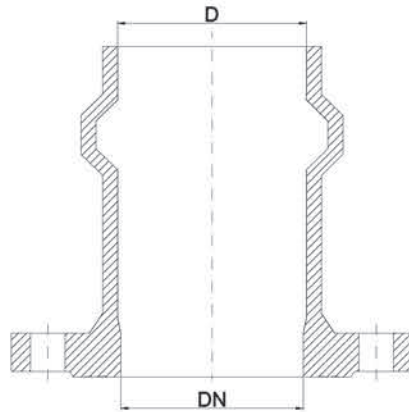

**FOR PVC PIPES
GF PIECES - FLANGED DOVETAILED F**

NORMAL DIA NW	D	WEIGHT KG
50	63	3,30
65	75	4,30
80	90	5,40
100	110	6,00
110	125	9,00
125	140	9,10
150	160	11,60
175	200	17,00
200	225	20,00
225	250	27,00
250	280	29,00
300	315	44,00
350	355	60,00
400	400	72,00

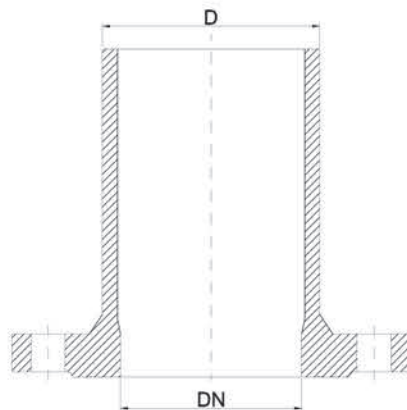

**FOR PVC PIPES
GQ PIECES - DOVETAILED BLUNT BUNG**

NORMAL DIA NW	D	WEIGHT KG
50	63	1,70
65	75	2,40
80	90	3,30
100	110	4,80
110	125	6,20
125	140	7,60
150	160	10,20
175	200	17,60
200	225	20,30
225	250	28,00
250	280	36,50
300	315	54,00
350	355	65,00
400	400	81,00

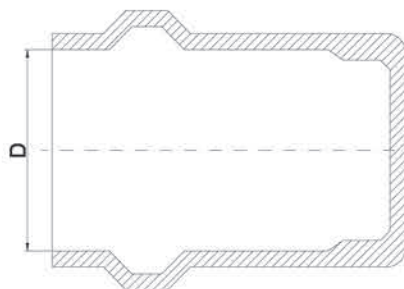

T PIECES WITH THREE FLANGED PT PIECES



DN1	DN2	WEIGHT KG
50	50	12,00
65	50	18,50
65	65	20,00
80	50	20,00
80	65	20,80
80	80	21,00
100	50	24,00
100	65	24,70
100	80	25,00
100	100	26,00
125	50	27,00
125	65	31,00
125	80	32,00
125	100	34,00
125	125	36,00
150	50	38,00
150	65	40,00
150	80	41,00
150	100	42,00
150	125	45,00
150	150	47,00
200	50	60,00
200	65	61,00
200	80	62,00
200	100	63,00
200	125	66,00
200	150	68,00
200	200	74,00
250	50	86,00
250	65	88,00
250	80	89,00
250	100	90,00
250	125	93,00
250	150	96,00
250	200	102,00
250	250	109,00
300	50	115,00

DN1	DN2	WEIGHT KG
300	65	118,00
300	80	120,00
300	100	124,00
300	125	126,00
300	150	129,00
300	200	136,00
300	250	143,00
300	300	151,00
350	100	162,00
350	125	163,00
350	150	165,00
350	200	169,00
350	250	175,00
350	300	188,00
350	350	195,00
400	100	205,00
400	125	206,00
400	150	208,00
400	200	211,00
400	250	215,00
400	300	232,00
400	350	239,00
400	400	246,00
500	150	310,00
500	200	312,00
500	250	315,00
500	300	334,00
500	350	342,00
500	400	349,00
500	500	363,00
600	200	450,00
600	250	460,00
600	300	466,00
600	350	475,00
600	400	485,00
600	500	499,00
600	600	516,00

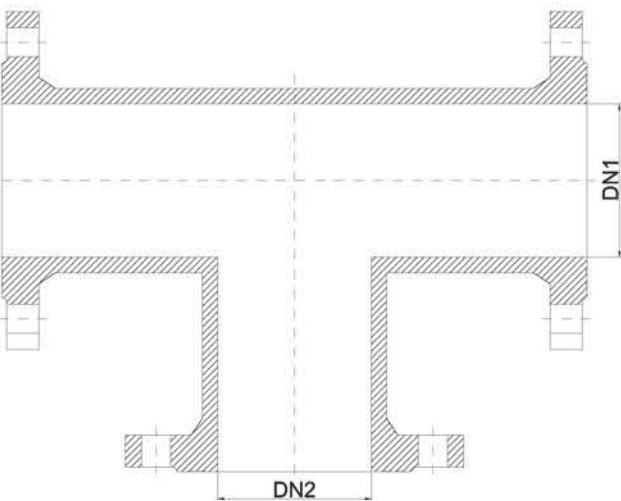

PIPES WITH TWO FLANGED FF PIECES

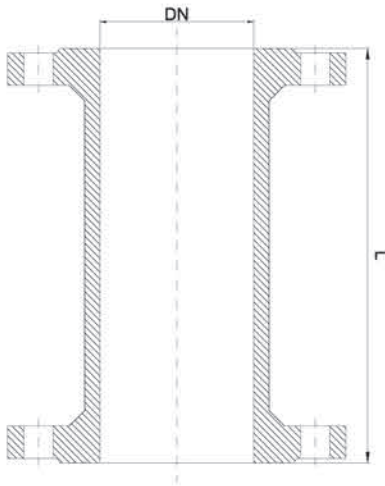

DN \ L	10CM	20 CM	30 CM	40 CM	50 CM	60 CM	70 CM	80 CM	90 CM	100 CM
80	10,50	12,50	15,00	17,00	19,00	21,00	23,50	25,00	27,50	29,00
100	12,00	14,50	17,50	19,50	22,50	24,50	27,50	30,00	33,00	35,00
125	16,00	19,50	23,00	26,50	29,50	33,00	36,00	39,50	43,00	46,50
150	19,50	24,00	28,00	32,00	36,00	41,00	45,00	49,00	53,00	57,50
200	27,50	34,00	39,50	46,00	52,50	58,00	64,50	70,00	76,50	85,00
250	37,00	45,50	53,50	61,50	70,00	78,00	86,00	94,50	103,00	111,00
300		53,00	63,00	74,50	84,50	95,50	106,00	117,00	128,00	138,00
350		69,00	83,00	96,00	109,00	123,00	136,00	149,00	162,00	176,00
400		86,00	102,00	117,00	133,00	149,00	165,00	180,00	196,00	211,00
500		114,00	136,00	157,00	178,00	200,00	222,00	244,00	265,00	286,00
600			172,00	200,00	228,00	254,00	282,00	309,00	337,00	365,00
700			237,00	296,00	305,00	340,00	376,00	412,00	447,00	484,00
800				355,00	400,00	446,00	491,00	535,00	582,00	627,00
900				416,00	470,00	525,00	570,00	634,00	600,00	724,00
1000				517,00	582,00	646,00	711,00	775,00	639,00	904,00

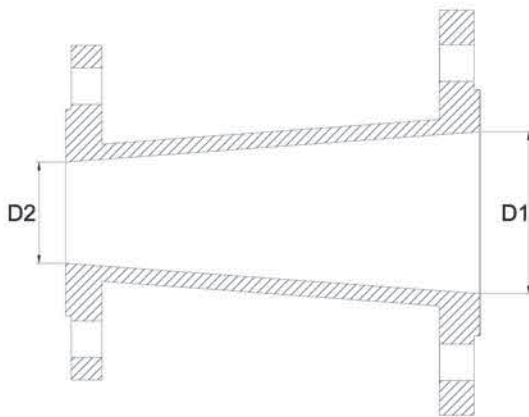

FRR PIECES REDUCTIONS WITH TWO FLANGED TIPS

D1	D2	WEIGHT KG	D1	D2	WEIGHT KG	D1	D2	WEIGHT KG
65	50	8,00	200	100	31,00	350	250	96,00
80	50	9,00	200	125	34,00	350	300	106,00
80	65	10,40	200	150	37,00	400	200	108,00
100	50	11,00	250	100	41,00	400	250	110,00
100	65	11,40	250	125	42,00	400	300	120,00
100	80	12,60	250	150	44,00	400	350	132,00
125	80	20,00	250	200	50,00	500	300	155,00
125	100	22,00	300	150	52,00	500	350	160,00
150	80	23,00	300	200	58,00	500	400	175,00
150	100	25,00	300	250	65,00	600	400	210,00
150	125	27,00	350	200	87,00	600	500	240,00



FLANGED STEEL



PN 10							PN 16						
DN	ØD	Øk	Ød	l _{xn}	C	f	ØD	Øk	Ød	l _{xn}	C	f	
40	150	110	84	Ø19X4	18	3	150	110	84	Ø19X4	18	3	
50	165	125	99	Ø19X4	20	3	165	125	99	Ø19X4	20	3	
65	185	145	118	Ø19X4	20	3	185	145	118	Ø19X4	20	3	
80	200	160	132	Ø19X8	22	3	200	160	132	Ø19X8	22	3	
100	220	180	156	Ø19X8	24	3	220	180	156	Ø19X8	24	3	
125	250	210	184	Ø19X8	26	3	250	210	184	Ø19X8	26	3	
150	285	240	211	Ø23X8	26	3	285	240	211	Ø23X8	26	3	
200	340	295	266	Ø23X8	26	4	340	295	266	Ø23X12	30	4	
250	395	350	319	Ø23X12	28	4	405	355	319	Ø28X12	32	4	
300	445	400	370	Ø23X12	28	4	460	410	370	Ø28X12	32	4	
350	505	460	429	Ø23X16	30	4	520	470	429	Ø28X16	36	4	
400	565	515	480	Ø28X16	32	4	580	525	480	Ø31X16	38	4	
450	615	565	530	Ø28X20	32	4	640	585	548	Ø31X20	40	4	
500	670	620	582	Ø28X20	34	4	715	650	609	Ø34X20	42	4	
600	780	725	682	Ø31X20	36	5	840	770	720	Ø37X20	48	5	
700	895	840	794	Ø31X24	40	5	910	840	794	Ø37X24	54	5	
800	1015	950	901	Ø34X24	44	5	1025	950	901	Ø41X24	58	5	
900	1115	1050	1001	Ø34X28	46	5	1125	1050	1001	Ø41X28	62	5	
1000	1230	1160	1112	Ø37X28	50	5	1255	1170	1112	Ø44X28	66	5	

PN 25							PN 40						
DN	ØD	Øk	Ød	l _{xn}	C	f	ØD	Øk	Ød	l _{xn}	C	f	
40	150	110	84	Ø19X4	20	3	150	110	84	Ø19X4	20	3	
50	165	125	99	Ø19X4	22	3	165	125	99	Ø19X4	22	3	
65	185	145	118	Ø19X8	24	3	185	145	118	Ø19X8	24	3	
80	200	160	132	Ø19X8	26	3	200	160	132	Ø19X8	26	3	
100	235	190	156	Ø23X8	28	3	235	190	156	Ø23X8	28	3	
125	270	220	184	Ø28X8	30	3	270	220	184	Ø28X8	30	3	
150	300	250	211	Ø28X8	34	3	300	250	211	Ø28X8	34	3	
200	360	310	274	Ø28X12	34	4	375	320	284	Ø31X12	40	4	
250	425	370	330	Ø31X12	36	4	450	385	345	Ø34X12	46	4	
300	485	430	389	Ø31X16	40	4	515	450	409	Ø34X16	50	4	
350	555	490	448	Ø34X16	44	4	580	510	465	Ø37X16	54	4	
400	620	550	503	Ø37X16	48	4	660	585	535	Ø41X16	62	4	
450	670	600	548	Ø37X20	50	4	685	610	560	Ø41X20		4	
500	730	660	609	Ø37X20	52	4	755	670	615	Ø44X20		4	
600	845	770	720	Ø41X20	56	5	890	795	735	Ø50X20		5	
700	960	875	820	Ø44X24		5							
800	1085	990	928	Ø50X24		5							
900	1185	1090	1028	Ø50X28		5							
1000	1320	1210	1140	Ø57X28		5							

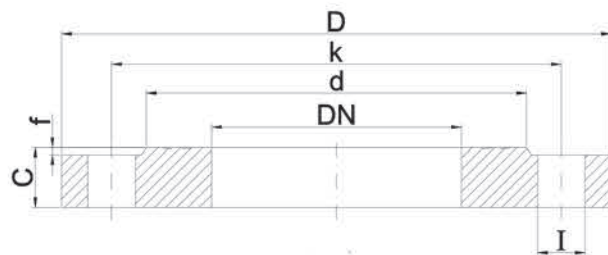
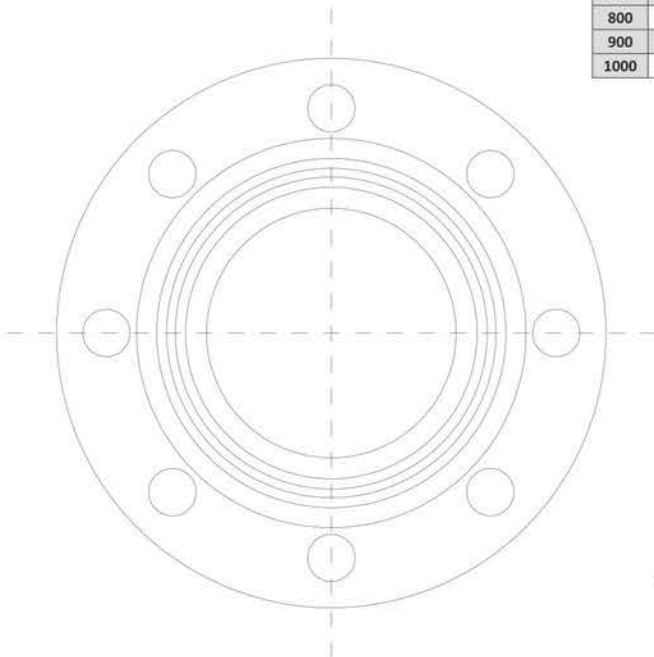

CREPINE

DN	H
50	160
65	190
80	195
100	235
125	250
150	310
200	400
250	415
300	485
350	605
400	670
500	800

NO	NAME OF PART
1	FLANGE
2	STEEL SHEET
3	STEEL SHEET

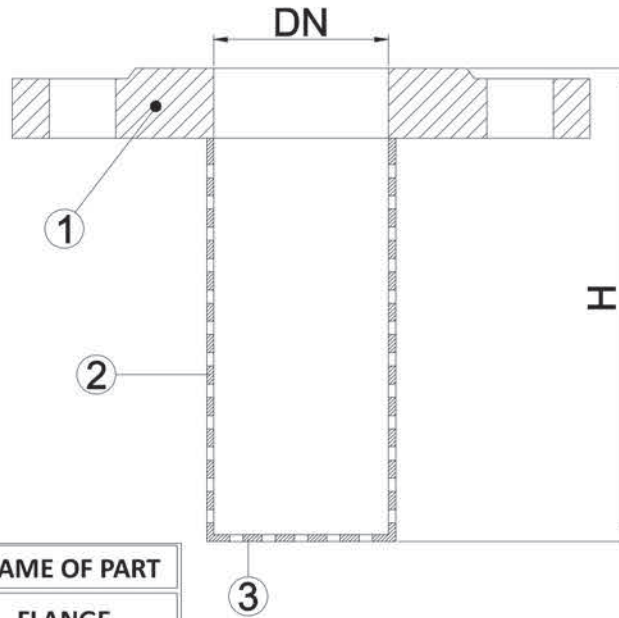

**Optional galvanized and stainless steel construction.*

AIR MANHOLE

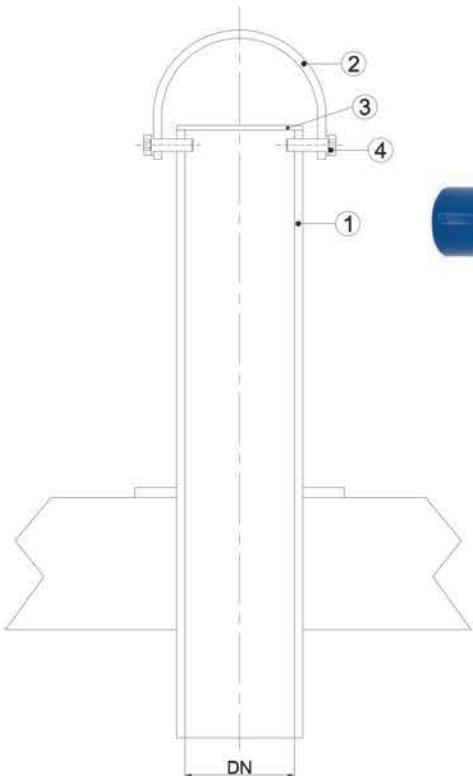

AIR STACK PART			DN
NO	NAME OF PART	MATERIAL	
1	PIPE	STEEL	80
2	CAP	EN-GJL-250 (GG25) EN-GJS-400 (GGG40) EN-GJS-500 (GGG50)	100
3	FILTER	STEEL SHEET	125
4	BOLT	8.8 BOLT	150
			200

VALVE CHAMBER SET



VALVE CHAMBER SET PARTS		
NO	NAME OF PART	MATERIAL
1	TANK HOUSING	EN-GJL-250 (GG25) EN-GJS-400 (GGG40) EN-GJS-500 (GGG50)
2	TANK COVER	EN-GJS-400 (GGG40) EN-GJS-500 (GGG50)
3	COVER CONNECTION BOLT-NUT	6.8 BOLT NUT
4	ROD-UPPERLOWER CASTING	EN-GJS-400 (GGG40) EN-GJS-500 (GGG50)
5	ROD IRON	16x16 SQUARE IRON
6	FUNNEL	PLASTIC

VALVE CHAMBER SET DIMENSION TABLE										
DN	D	D1	D2	H	H1	H2	k	Weight		
								Tanka	Rod	Total
50	136	213	119	142	500	540	19	5,2	2	7,2
65	136	213	119	142	500	540	20	5,2	2	7,2
80	136	213	119	142	500	540	20	5,2	2	7,2
100	136	213	119	142	500	540	21	5,2	2	7,2
125	136	213	119	142	500	540	23	5,2	2	7,2
150	136	213	119	142	500	540	23	5,2	2	7,2
200	163	248	146	204	400	540	25	9,3	2	11,3
250	163	248	146	204	400	540	28	9,3	2,5	11,8
300	163	248	146	204	400	540	28	9,3	2,5	11,8
350	163	248	146	204	400	540	30	9,3	3	12,3
400	163	248	146	204	400	540	33	9,3	3	12,3
500	163	248	146	204	400	540	33	9,3	3	12,3

SUBSCRIBER CHAMBER BOILER



PARTS OF ELECTROFUSION TANK			
NO	NAME OF PART	MATERIAL	WEIGHT(Kg)
1	TANK BODY	EN-GJL-250 (GG25) EN-GJS-400 (GGG40) EN-GJS-500 (GGG50)	5,5
2	TANK COVER	EN-GJS-400 (GGG40) EN-GJS-500 (GGG50)	
3	COVER JOINT BOLT-LOAF	6.8 BOLT LOAF	

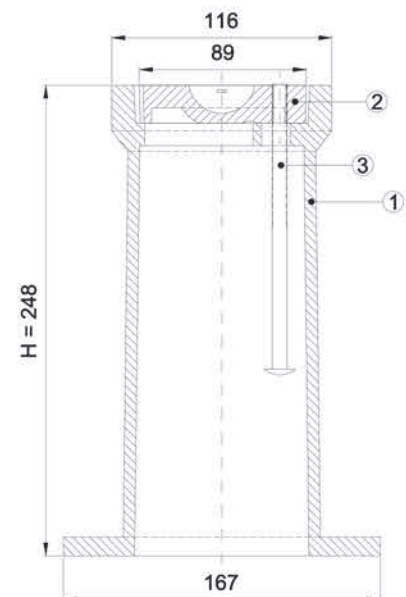

BLEND WITH TWO FLANGED MMQ PIECES

NORMINAL DIA NW	ANGLE	WEIGHT KG
50	90°	9,50
65	90°	12,00
80	90°	13,00
100	90°	17,00
125	90°	23,00
150	90°	31,00
200	90°	49,00
250	90°	72,00
300	90°	100,00
350	90°	137,00
400	90°	181,00
500	90°	290,00
600	90°	442,00

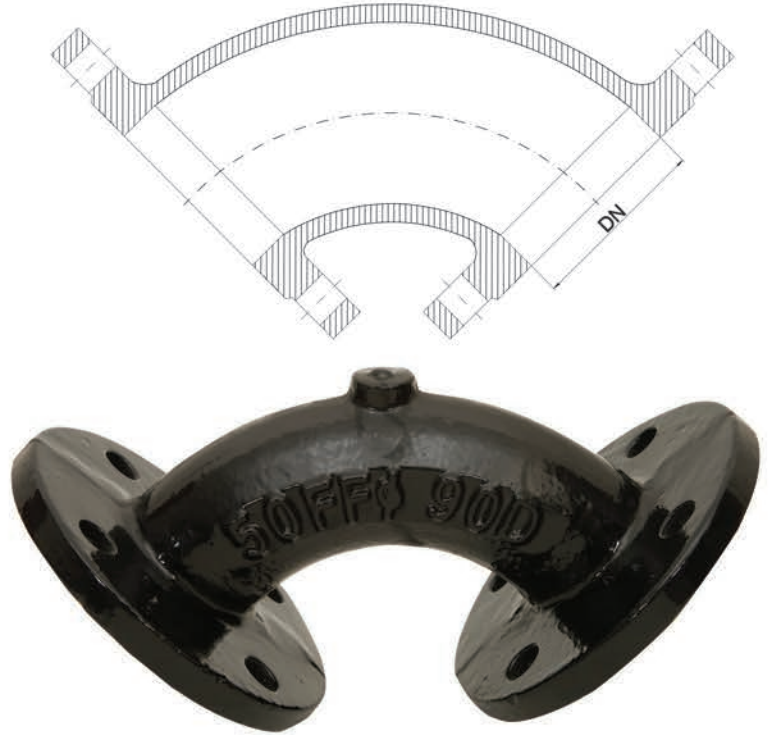

BLUNT FLANGED X PIECES

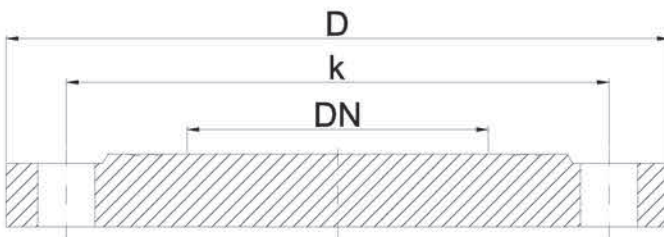

NORMINAL DIA NW	D	k	WEIGHT KG
50	165	125	2,50
65	185	145	3,50
80	200	160	4,50
100	220	180	5,50
125	250	210	7,50
150	285	240	8,50
200	340	295	15,00
250	400	350	28,00
300	445	400	32,00
350	505	460	43,00
400	565	515	55,00





K.O.S.B. Büyükkayacık Mah. 410 Nolu Sokak
No:7 Selçuklu / KONYA
T : 0332 342 07 24 | 0 332 342 12 68
F : 0332 342 01 77
bilgi@pinarvana.com.tr
www.pinarvana.com.tr